

Installation Instructions

84887

Auger Bed Liner

John Deere

9670 STS, 9770 STS, 9860 STS, 9870 STS, 9880 STS,
S650, S660, S670, S680, S685, S690, S760, S770, S780, S790



CAUTION

PLEASE REFER TO YOUR EQUIPMENT MANUFACTURER'S
OPERATORS MANUAL FOR PERTINENT SAFETY PRECAUTIONS



IMPORTANT

Read all instructions before starting installation of liner

Kit Contents:

- #22881 - Poly Panel 12" Wide X 30-3/4" White (Qty. 4)
- #22147 - SST Strap 2" X 24" X 15° Bend (Qty. 12)
- #22440 - Shim White 2" X 6" X 1/8" (Qty. 6)
- #41596 - Grain Tank Hardware Kit (Qty. 1)

Tools Required:

- Safety Glasses or Goggles
- Rivet Gun, capable of installing a 3/16" steel rivet with steel mandrel
- Drill

****When using power tools, basic safety precautions should always be followed to reduce the risk of personal injury***

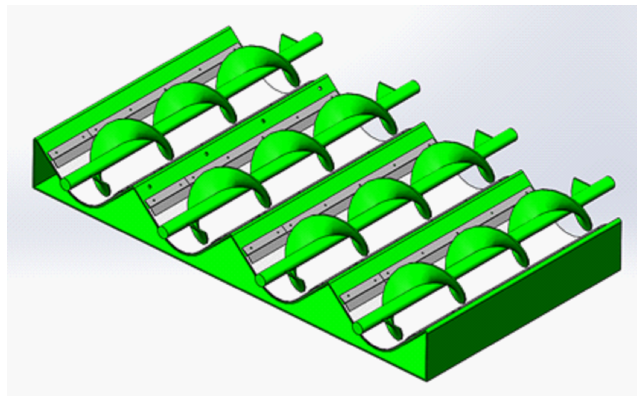

120 Eastgate Drive SE
Hutchinson, MN 55350

1-800-788-6483
1-320-587-2322
1-320-587-6112 (Fax)

WWW.MAYWES.COM

Auger Bed Liner Installation Instructions

Installation

Step 1 - Clean auger troughs to remove all dirt and crop residue.

Step 2 - Insert Poly Liner under the auger, sliding liner to the back until it makes contact with the housing.



Step 3 - Use shims (if required) to hold liner down tight against auger bed floor.



MAY WES
Original Poly People
A DIVISION OF PRIDE SOLUTIONS

120 Eastgate Drive SE
Hutchinson, MN 55350

1-800-788-6483
1-320-587-2322
1-320-587-6112 (Fax)

WWW.MAYWES.COM

Auger Bed Liner Installation Instructions

Step 4 - Install rear hold down straps first. Place the strap that it overlaps the poly liner and hold down. Using hold down strap as a guide, drill 13/64" holes through the auger bed and rivet into place. Install the rest of the hold down straps end to end; making sure front straps are parallel to rear straps. Drill and rivet into place. Trimming of SST straps might be required, cut to fit final strap in place. Make sure to add another hole approximately 1" from end of strip if hole is removed



Step 5 - Repeat steps 2, 3 and 4 for each additional auger bed.

Step 6 - If used, remove shims and re-adjust auger height to desired clearance.



MAY WES
Original Poly People
A DIVISION OF PRIDE SOLUTIONS

120 Eastgate Drive SE
Hutchinson, MN 55350

1-800-788-6483
1-320-587-2322
1-320-587-6112 (Fax)

WWW.MAYWES.COM