



The Original Farmer Designed
59711 U.S. Hwy 12, Litchfield, MN 55355
1-888-485-8411

Assembly Instructions AGCO 3000 & Hugger-20” Center (2016 or 2016-S) (H 2023 or H 2023-S)



Picture #1



Picture #2



Picture #3



Picture #4

(Step 1 & 2 are for heads with metal shields)

1. Remove all hinges, hinge brackets from the head. (Save All Bolts)
2. Bolt the 2” x 2” mounting angle (**Item #11**) in 1/2” holes that were used to hold the original hinge bracket. Use the original 1/2” bolts and washers (**Leave Loose.**) to fasten the 2” part of the mounting angle against the head.
3. Bolt the hinging bracket (**Item #9**) to the mounting angle, using the 1/2” x 1 1/2” Carriage bolts and nuts.
4. Make sure the Gathering Chains **Do Not** hit the brackets. **Tighten all the bolts.**
5. Install the hook mounting bracket (**Item #10**) in the slotted holes in the Gatherer Shields frame using the 3/8” x 1” carriage bolts. (**Put the Lip of the bracket pointing upward**) **Leave Loose (Picture # 2)**
6. Bolt the hook part of the hinge (a Gleaner Part) to the hook mounting bracket. **Leave Loose (Picture #2)**
7. Install the rear hold-down brackets (**Item #7**), using the two back 5/16” bolts. Use 5/16” nuts on the bottom side for extra strength. (**Picture #3**)
8. Hook the Gatherer Shields on to the head and set it down in the back.
9. Push the Gatherer Shields tightly toward the back and center it. Then **Tighten all the hinge bolts.**
10. Loosen the hold-down pin (**Item #12**) and center it, so the Gatherer Shields will slide over the pin.
11. Adjust the pin up or down so the lynch pin (**Item #15**) fits snug **5/8” washer goes under the lynch pin.** Make sure to **tighten** the hold-down pin nuts. (**Picture #4**)
12. The PVC pipe around the adjustment chain **must be removed.** (**For shipping only**)
13. Use extra 1/4” x 3/4” screws and fender washers to fasten the rubber ear savers. (**Optional**) (**Drill no larger than 1/8” holes for this.**)

Part and Item numbers may look different because of new changes made to frame.

ITEM NO.	PART NUMBER	DESCRIPTION	QTY.	ITEM NO.	PART NUMBER	DESCRIPTION	QTY.
36	UN 21001	SS WEAR STRIPS-LEFT EDGE	1	1	XX 02001	20" CENTER BACK RED	1
37	UN 21002	SS WEAR STRIPS-RIGHT EDGE	1	2	XX 12000-S	20" SHORT CENTER GATHERER FRONT	1
38	ES-GVL	GVL EAR SAVER	2	3	XX 12000	20" LONG CENTER GATH FRONT	1
				4	UN 12002	20" UNI MAIN FRAME	1
				5	UN 12003-S	20" FRONT GATH BRKT-SHORT	1
				6	UN 12003	20" FRONT GATH BRKT-LONG	1
				7	DA 02014	20" REAR HOLD DOWN BRKT-3000	1
				8	DA 00009	HOOK-HUGGER SERIES	2
				9	DA 02019	22" LOWER HINGING BRACKET	1
				10	DA 02012	20" FRONT HINGING BRACKET	1
				11	DA 02022	HINGING BRACKET MOUNTING ANGLE	2
				12	58-4 HDP	5/8"x4" LG HOLD DOWN PIN	1
				13	58-JN	5/8" JAM NUT	1
				14	58-W SAE	5/8" SAE WASHER	1
				15	14-LP	1/4" LYNCH PIN	1
				16	PCC-316	3/16 PROOF COIL CHAIN	19
				17	38-3 UB	3/8"x3" U-BOLT	1
				18	516-34 HB	5/16"x3/4" HX HD BOLT	8
				19	516-W USS	5/16" USS FLAT WASHER	4
				20	38-1 HB	3/8"x1" HX HD BOLT	1
				21	38-W USS	3/8" USS FLAT WASHER	3
				22	38-1 CB	3/8"x1" CARR BOLT-SHORT NECK	6
				23	38-134 THB	3/8"x1 3/4" TRUSS HEAD BOLT	4
				24	38-FSN	3/8" FLANGE SERRATED NUT	11
				25	38-NLN	3/8" NYLON LOCK NUT	2
				26	12-150 MHB	12X150 HX HD METRIC BOLT	2
				27	12-112 CB	1/2"x1 1/2" CARR BOLT	4
				28	12-114 HB	1/2"x1 1/4" HX HD BOLT	4
				29	12-MLN	12 METRIC LOCK NUT	2
				30	12-FSN	1/2" FLANGE SERRATED NUT	4
				31	12-W SAE	1/2" SAE WASHER	6
				32	14-34 TTS	1/4"x3/4" TR TAPPING SCREW	10
				33	WP-96	Wear Point	1
				34	SN-531	SERIAL NUMBER TAG	1
				35	516-W F	5/16 FENDER WASHER	4

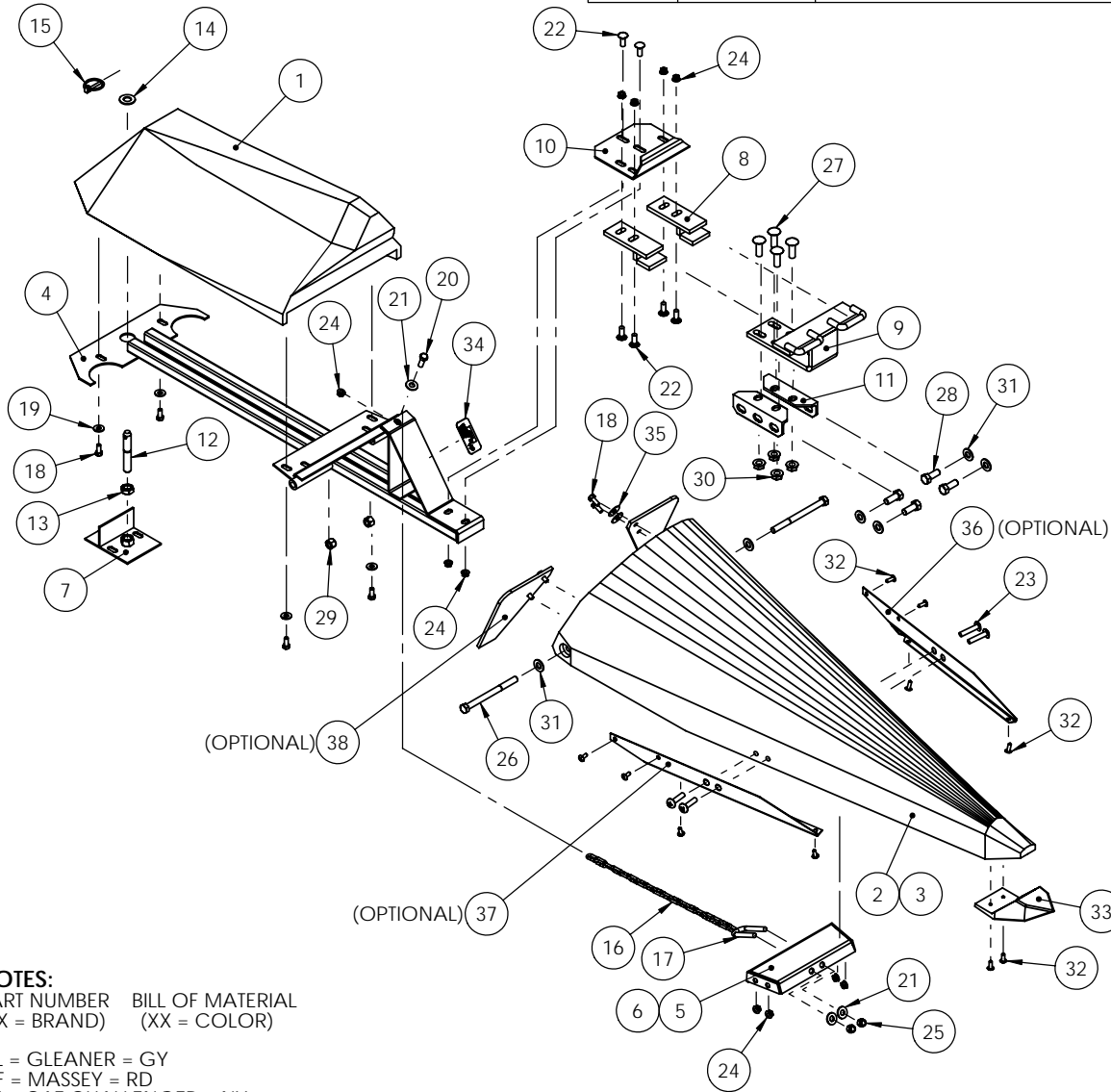

NOTES:
PART NUMBER BILL OF MATERIAL
(XX = BRAND) (XX = COLOR)

GL = GLEANER = GY
MF = MASSEY = RD
CT = CAT CHALLENGER = NY

NAME	DATE	GVL		
DRAWN ALS	5/16/08	TITLE: AGCO 20" CENTER GVL I		
CHECKED				
ENG APPR.				
MFG APPR.				
Q.A.				
COMMENTS:		SIZE B	DWG. NO. XX H 2023-S, XX H 2023 XX 2016-S, XX 2016	REV
		SCALE: 1:10	WEIGHT:	SHEET 1 OF 1

PROPRIETARY AND CONFIDENTIAL
THE INFORMATION CONTAINED IN THIS DRAWING IS THE SOLE PROPERTY OF GVL. ANY REPRODUCTION IN PART OR AS A WHOLE WITHOUT THE WRITTEN PERMISSION OF GVL IS PROHIBITED.