



The Original Farmer Designed
59711 U.S. Hwy 12, Litchfield, MN 55355
1-888-485-8411

Assembly Instructions AGCO 3000 & Hugger-22" Center (2216 or 2216-S) (H 2223 or H 2223-S)



Picture #1



Picture #2



Picture #3



Picture #4

(Step 1 & 2 are for heads with metal shields)

1. Remove all hinges, hinge brackets from the head. (Save All Bolts)
2. Bolt the 2" x 2" mounting angle (**Item #11**) in 1/2" holes that were used to hold the original hinge bracket. Use the original 1/2" bolts and washers (**Leave Loose.**) to fasten the 2" part of the mounting angle against the head.
3. Bolt the hinging bracket (**Item #10**) to the mounting angle, using the 1/2" x 1 1/2" Carriage bolts and nuts.
4. Make sure the Gathering Chains **Do Not** hit the brackets. **Tighten all the bolts.**
5. Install the hook mounting bracket (**Item #9**) in the slotted holes in the Gatherer Shields frame using the 3/8" x 1" carriage bolts. (**Put the Lip of the bracket pointing upward**) **Leave Loose (Picture # 2)**
6. Bolt the hook part of the hinge (a Gleaner Part) to the hook mounting bracket. **Leave Loose (Picture #2)**
7. Install the rear hold-down brackets (**Item #8**), using the two back 5/16" bolts. Use 5/16" nuts on the bottom side for extra strength. (**Picture #3**)
8. Hook the Gatherer Shields on to the head and set it down in the back.
9. Push the Gatherer Shields tightly toward the back and center it. Then **Tighten all the hinge bolts.**
10. Loosen the hold-down pin (**Item #13**) and center it, so the Gatherer Shields will slide over the pin.
11. Adjust the pin up or down so the lynch pin (**Item #16**) fits snug **5/8" washer goes under the lynch pin.** Make sure to **tighten** the hold-down pin nuts. (**Picture #4**)
12. The PVC pipe around the adjustment chain **must be removed.** (**For shipping only**)
13. Use extra 1/4" x 3/4" screws and fender washers to fasten the rubber ear savers. (**Optional**) (**Drill no larger than 1/8" holes for this.**)

Part and Item numbers may look different because of new changes made to frame.

| ITEM NO. | PART NUMBER | DESCRIPTION | QTY. | ITEM NO. | PART NUMBER | DESCRIPTION | QTY. |
|----------|-------------|---------------------------|------|----------|-------------|---------------------------------|------|
| 37 | UN 21001 | SS WEAR SRTIPS-LEFT EDGE | 1 | 1 | XX 02201 | 22" CENTER BACK | 1 |
| 38 | UN 21002 | SS WEAR SRTIPS-RIGHT EDGE | 1 | 2 | XX 12200-S | 22" SHORT CENTER GATHERER FRONT | 1 |
| 39 | ES-GVL | GVL EAR SAVER | 2 | 3 | XX 12200 | 22" LONG CENTER GATHERER FRONT | 1 |
| | | | | 4 | UN 12202 | 22" UNI MAIN FRAME | 1 |
| | | | | 5 | UN 12203-S | 22" FRONT GATH BRKT-SHORT | 1 |
| | | | | 6 | UN 12203 | 22" FRONT GATH BRKT-LONG | 1 |
| | | | | 7 | DA 00009 | HOOK-HUGGER SERIES | 2 |
| | | | | 8 | DA 02214 | 22" REAR HOLD DOWN BRKT-3000 | 1 |
| | | | | 9 | DA 02212 | 22" FRONT HINGING BRACKET | 1 |
| | | | | 10 | DA 02219 | 22" LOWER HINGING BRACKET | 1 |
| | | | | 11 | DA 02022 | HINGING BRACKET MOUNTING ANGLE | 2 |
| | | | | 12 | UN 00006 | 5/8" JAM NUT PLATE | 1 |
| | | | | 13 | 58-4 HDP | 5/8"x4" LG HOLD DOWN PIN | 1 |
| | | | | 14 | 58-JN | 5/8" JAM NUT | 1 |
| | | | | 15 | 58-W SAE | 5/8" SAE WASHER | 2 |
| | | | | 16 | 14-LP | 1/4" LYNCH PIN | 1 |
| | | | | 17 | PCC-316 | 3/16 PROOF COIL CHAIN | 19 |
| | | | | 18 | 516-34 HB | 5/16"x3/4" HX HD BOLT | 8 |
| | | | | 19 | 516-W USS | 5/16" USS FLAT WASHER | 4 |
| | | | | 20 | 38-3 UB | 3/8"x3" U-BOLT | 1 |
| | | | | 21 | 38-W USS | 3/8" USS FLAT WASHER | 3 |
| | | | | 22 | 38-1 CB | 3/8"x1" CARR BOLT-SHORT NECK | 8 |
| | | | | 23 | 38-1 HB | 3/8"x1" HX HD BOLT | 1 |
| | | | | 24 | 38-134 THB | 3/8"x1 3/4" TRUSS HEAD BOLT | 4 |
| | | | | 25 | 38-FSN | 3/8" FLANGE SERRATED NUT | 13 |
| | | | | 26 | 38-NLN | 3/8" NYLON LOCK NUT | 2 |
| | | | | 27 | 12-150 MHB | 12X150 HX HD METRIC BOLT | 2 |
| | | | | 28 | 12-112 CB | 1/2"x1 1/2" CARR BOLT | 4 |
| | | | | 29 | 12-114 HB | 1/2"x1 1/4" HX HD BOLT | 4 |
| | | | | 30 | 12-MLN | 12 METRIC LOCK NUT | 2 |
| | | | | 31 | 12-FSN | 1/2" FLANGE SERRATED NUT | 4 |
| | | | | 32 | 12-W SAE | 1/2" SAE WASHER | 6 |
| | | | | 33 | 14-34 TTS | 1/4"x3/4" TR TAPPING SCREW | 10 |
| | | | | 34 | WP-96 | Wear Point | 1 |
| | | | | 35 | SN-531 | SERIAL NUMBER TAG | 1 |
| | | | | 36 | 516-W F | 5/16 FENDER WASHER | 4 |

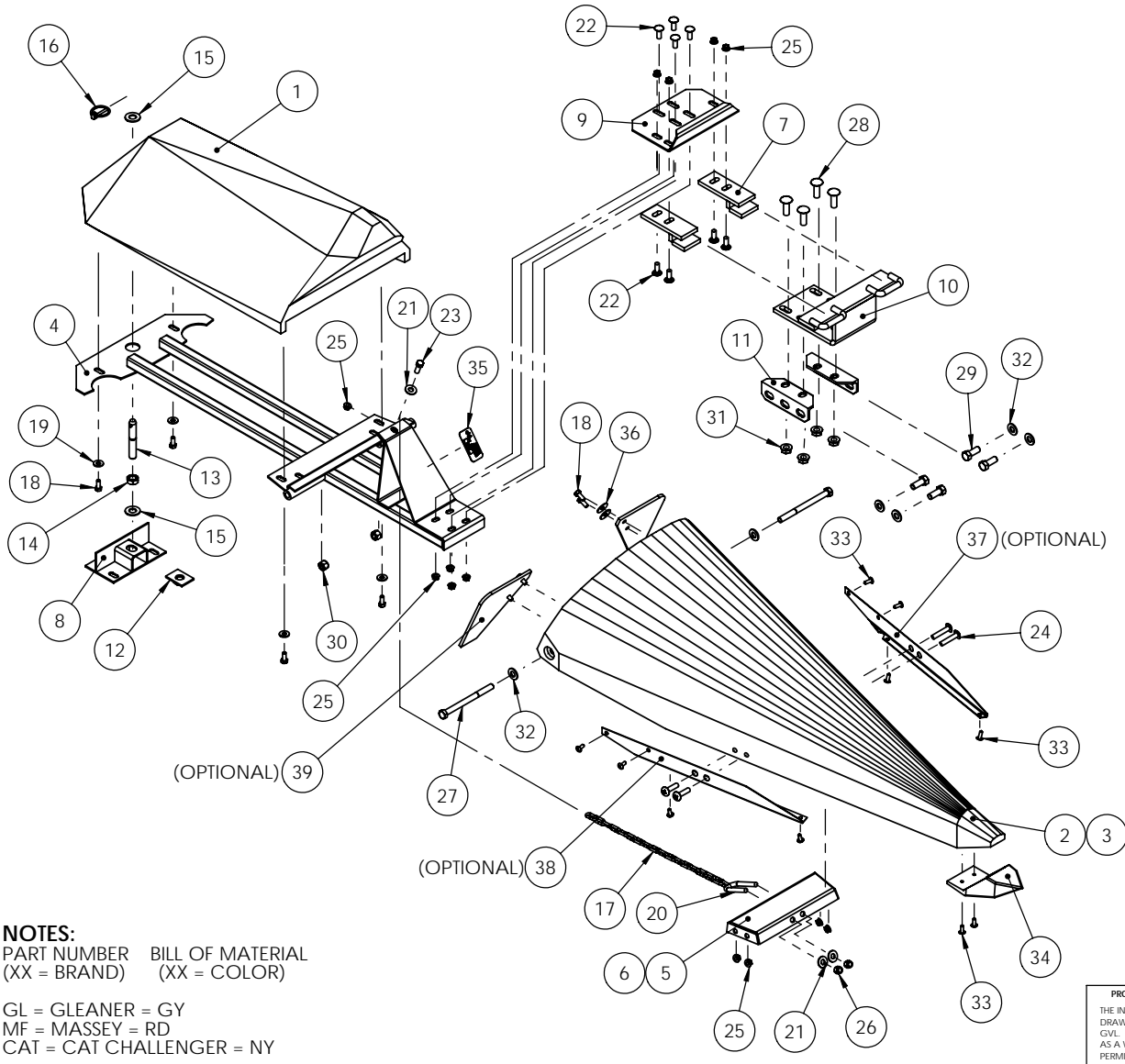

NOTES:
 PART NUMBER BILL OF MATERIAL
 (XX = BRAND) (XX = COLOR)

GL = GLEANER = GY
 MF = MASSEY = RD
 CAT = CAT CHALLENGER = NY

PROPRIETARY AND CONFIDENTIAL
 THE INFORMATION CONTAINED IN THIS
 DRAWING IS THE SOLE PROPERTY OF
 GVL. ANY REPRODUCTION IN PART OR
 AS A WHOLE WITHOUT THE WRITTEN
 PERMISSION OF GVL IS PROHIBITED.

| NAME | DATE | GVL | |
|-----------|------|---------|--|
| DRAWN | ALS | 5/20/08 | TITLE: AGCO 22" CENTER GVL I |
| CHECKED | | | |
| ENG APPR. | | | |
| MFG APPR. | | | |
| Q.A. | | | |
| COMMENTS: | | | SIZE B |
| | | | DWG. NO. XX H 2223-S, XX H 2223 XX 2216-S, XX 2216 |
| | | | REV |
| | | | SCALE: 1:10 WEIGHT: |
| | | | SHEET 1 OF 1 |