

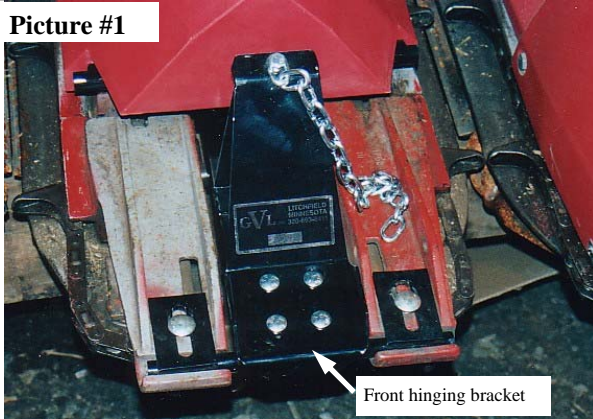

The Original Farmer Designed  
59711 U.S. Hwy 12, Litchfield, MN 55355  
1-888-485-8411

## Assembly Instructions Case IH 800 Series 20" Center GVL I (CI 82013-S or CI 82013)

Picture #1



Picture #2

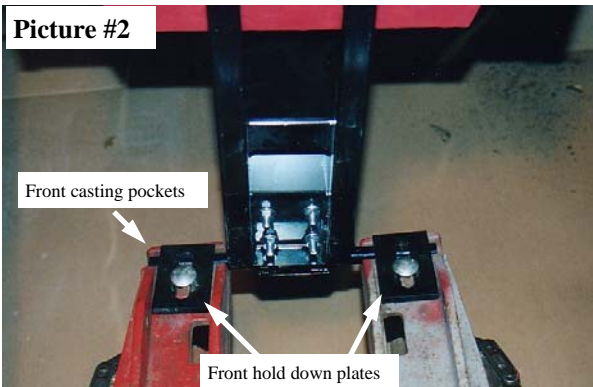

Picture #3

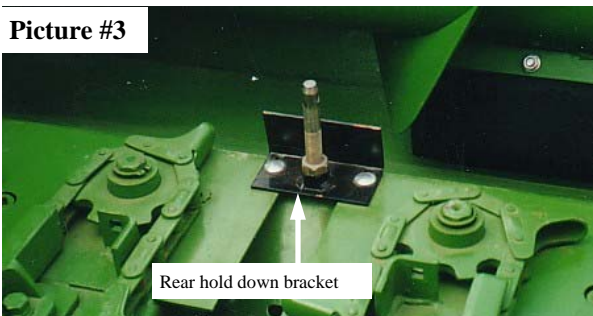

Picture #4



1. Remove metal Gatherer Shields.
2. Remove all hinges, brackets, latches and support rods.
3. Install the front hinging bracket (**Item #6**) to the front of Gatherer frame using 3/8" x 1" carriage bolts and nuts. (**Leave loose**) (**Picture #1**)
4. Install GVL Gatherer Shield (3/4" shaft sits in front casting pocket.) (**Picture #2**)
5. Use 3/4" washer (**Item #24**) over 3/4" shaft to eliminate side to side play.
6. Install front hold-down plates (**Item #7**) over the shafts on both sides and bolt them down with 1/2" carriage bolts and nuts. (**Tighten Nuts**) (**Picture #2**)
7. Position the Gatherer Shield all the way back and center the unit. Tighten the front hinging bracket. (**Item #6**)
8. Install rear hold-down pin (**Item #9**) through the hole in the back of the Gatherer.
9. Lower Gatherer Shield down on the corn head. (**May need to remove bolts in the corn-head so the rear hold-down bracket (Item #5) sits flat on the head.**)
10. Make sure the Gatherer Shield is centered in the back.
11. Hold the rear hold-down bracket (**Item #5**) down flat on the head and raise the Gatherer Shield. (**Picture #3**)
12. Mark the slotted holes, center punch them and drill 3/8" holes.
13. Bolt the rear hold-down bracket to the head using 3/8" carriage bolts. (**Leave loose**) (**Picture #3**)
14. Adjust the bracket so the pin is lined up with the hole in the Gatherer Shield.
15. Lock the Gatherer Shield down with 5/8" washer (**Item #19**) and lock pin (**Item #10**) (**Picture #4**)
16. Adjust the hold-down pin up or down so the lock pin go in snug. (Check yearly)
17. **Check to make sure the drive clutch and Gathering chain does not touch any bolts or pins.**
18. Remove PVC pipe that is around the adjustment chain. (**For shipping and handling only!**)
19. **Tighten all bolts and nuts.**

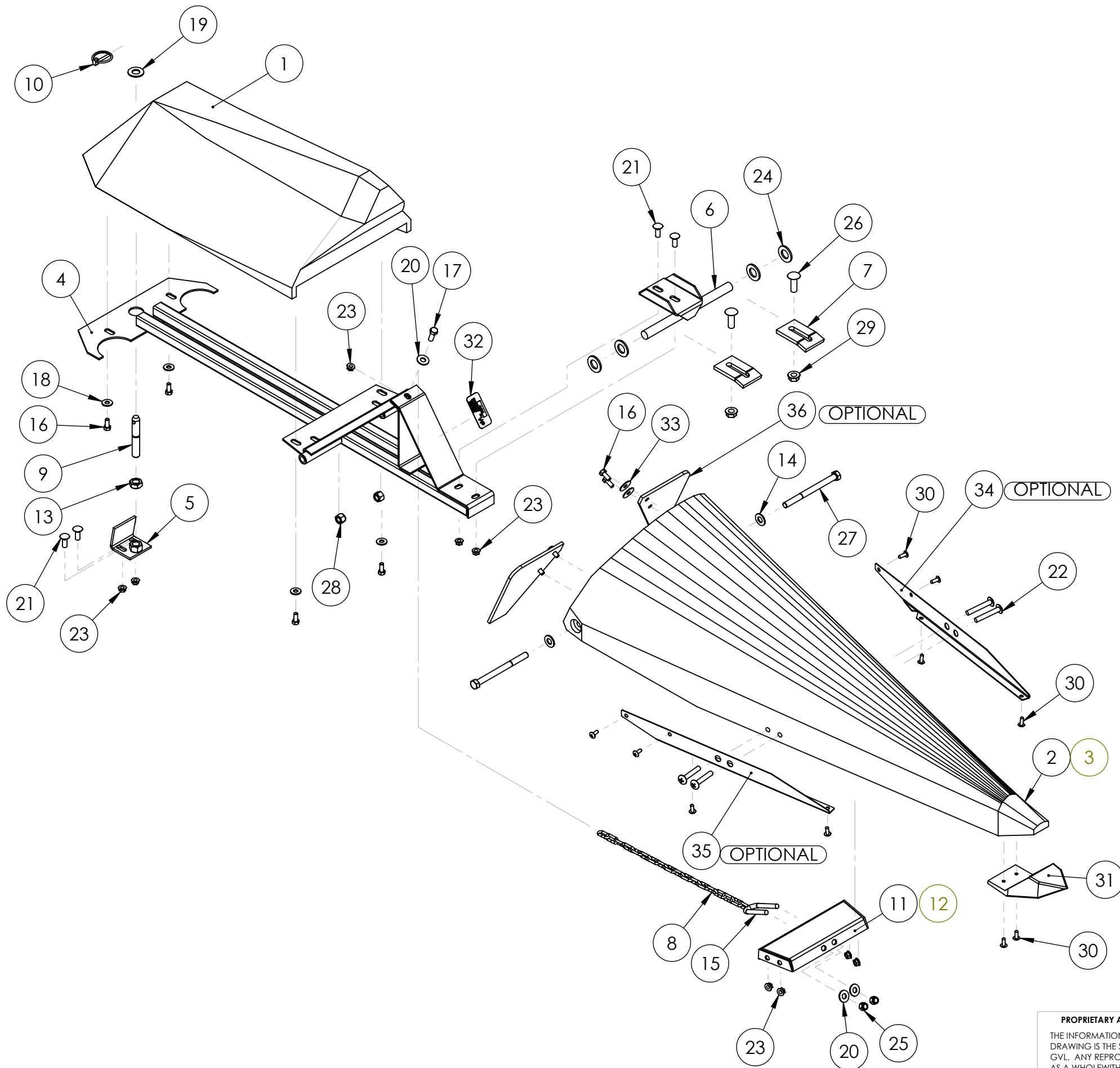

ITEM NO.	PART NUMBER	DESCRIPTION	QTY.
1	RD 02001	20" CENTER BACK RED	1
2	RD 12000-S	20" SHORT CENTER GATHERER FRONT RED	1
3	RD 12000	20" LONG CENTER GATHERER FRONT RED	1
4	UN 12002	20" UNI MAIN FRAME	1
5	JD 42004	20" REAR HOLD DOWN BRACKET	1
6	CI 82012	20" FRT HINGING BRKT	1
7	CI 00005	CI FRONT HOLD DOWN PLATE	2
8	PCC-316	3/16" PROOF CHAIN 19 LINK	1
9	58-4 HDP	5/8"x4" LG HOLD DOWN PIN	1
10	14-LP	1/4" LYNCH PIN	1
11	UN 12003-S	20" FRONT GATH BRKT-SHORT	1
12	UN 12003	20" FRONT GATH BRKT-LONG	1
13	58-JN	5/8" JAM NUT	1
14	12-W SAE	1/2" SAE WASHER	2
15	38-3 UB	3/8" X 3" U-BOLT	1
16	516-34 HB	5/16"x3/4" HX HD BOLT	8
17	38-1 HB	3/8"x1" HX HD BOLT	1
18	516-W USS	5/16" USS WASHER	4
19	58-W SAE	5/8" SAE WASHER	1
20	38-W USS	3/8" USS FLAT WASHER	3
21	38-1 CB	3/8"x1" CARR BOLT-SHORT NECK	4
22	38-134 THB	3/8" X 1-3/4" PHILLIPS TRUSS HEAD BOLT	4
23	38-FSN	3/8" FLANGE SERRATED NUT	9
24	34-W SAE	3/4" SAE WASHER	4
25	38-NLN	3/8" NYLON LOCK NUT	2
26	12-112 CB	1/2"x1 1/2" CARR BOLT	2
27	12-150 MHB	12X150MM HX HD METRIC BOLT	2
28	12-MLN	12mm METRIC LOCK NUT	2
29	12-FSN	1/2" FLANGE SERRATED NUT	2
30	14-34 TTS	1/4"x3/4" SELF TAP SCREW	10
31	WP-96	WHITE WEAR POINT	1
32	SN-531	SERIAL NUMBER TAG	1
33	516-W F	5/16 FENDER WASHER	4
34	UN 21001	SS WEAR STRIPS-LEFT EDGE	1
35	UN 21002	SS WEAR STRIPS-RIGHT EDGE	1
36	ESB-GVL	GVL EAR SAVER	2

**PROPRIETARY AND CONFIDENTIAL**  
 THE INFORMATION CONTAINED IN THIS DRAWING IS THE SOLE PROPERTY OF GVL. ANY REPRODUCTION IN PART OR AS A WHOLE WITHOUT THE WRITTEN PERMISSION OF GVL IS PROHIBITED.

	NAME	DATE
DRAWN	ALS	
CHECKED	MLB	11-13-12
ENG APPR.		
MFG APPR.		
Q.A.		
COMMENTS:		

**GVL POLY**

TITLE:  
**CI 20" 800 SERIES CENTER GVL I**

SIZE <b>B</b>	DWG. NO. <b>CI 82013-S CI 82013</b>	REV <b>A</b>
------------------	--	-----------------

SCALE: 1:9    WEIGHT:    SHEET 1 OF 1