

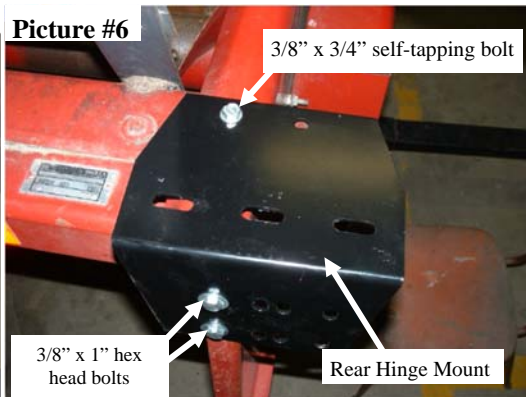

The Original Farmer Designed
 59711 U.S. Hwy 12, Litchfield, MN 55355
 1-888-485-8411

Assembly Instructions GVL II—Case IH 900/1000 Series 30 Right & Left End (CI 97725 & CI 96625)

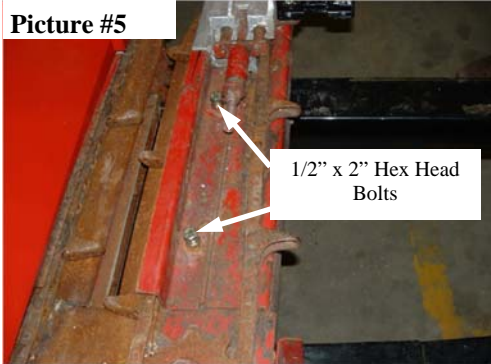
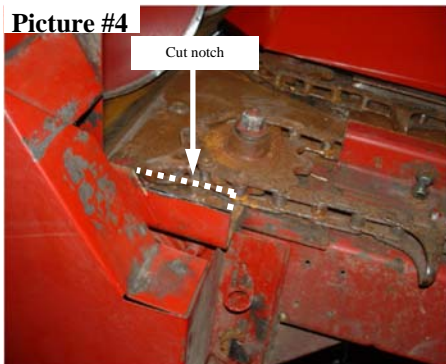
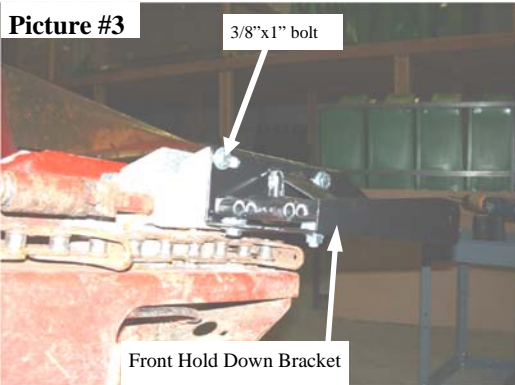
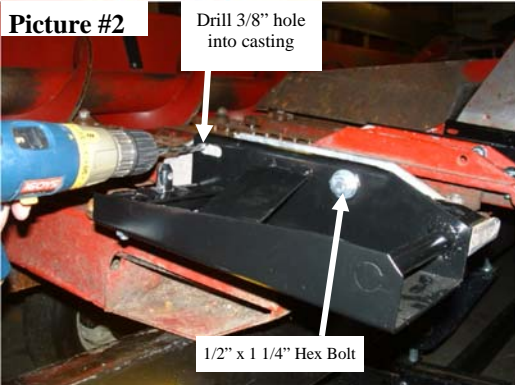
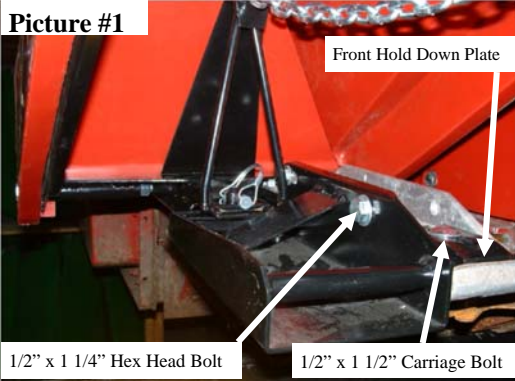

(Note: The following instruction is for a Right Hand Side. Use same instruction when assembling the Left Hand Side.)

1. Remove the old metal Gatherer and back angle bracket. (keep angle bracket for later use)
2. Install the Right Front Hold Down Mount to the front cast piece, using a 1/2" x 1 1/2" Carriage bolt, a 1/2" flanged serrated nut and the Front Hold Down Plate. **(Picture #1)**
3. Bolt the Front Hold Down Mount using the 1/2" x 1 1/4" hex head bolt, washer, and 1/2" flanged serrated nut to attach it to the cast piece. Level with row unit and tighten. **(Picture #1)**
4. Drill a 3/8" hole through the front cast at the rear of the slot of the front mounting bracket. Bolt the rear of the cast with a 3/8" x 1" hex bolt, washer and flanged serrated nut. **(Picture #2 and #3)**
5. Mount the Front Hold Down Bracket using the 3/8" x 1" Carriage bolts, washers and nuts. (Leave loose) **(Picture #3)**
6. Cut a notch out of the rear side end bracket, 3/4" down and 3 1/2" long. **(Picture #4)**
7. Replace the 1/2" x 3 1/2" chain guard/ stripper plate bolts with 1/2" x 2" Hex Bolt. (Provided) **(Picture #5)**
8. Attach the multi position Rear Hinge Mount to the back of the head and use the holes to align for the best fit. Mark and drill the rear holes using a 3/8" bit. (Top Hole is existing 5/16" hole) Use a 3/8" x 1" hex bolt, washers and nuts on the back. (Leave loose) Position The top hole of the bracket over the top center of the head end roll and drill a 5/16" hole. Fasten using the 3/8" x 3/4" self tapping bolt. Tighten all bolts. **(Picture #6)**



The Original Farmer Designed
59711 U.S. Hwy 12, Litchfield, MN 55355
1-888-485-8411

Assembly Instructions GVL II—Case IH 900/1000 Series 30 Right & Left End (CI 97725 & CI 96625)

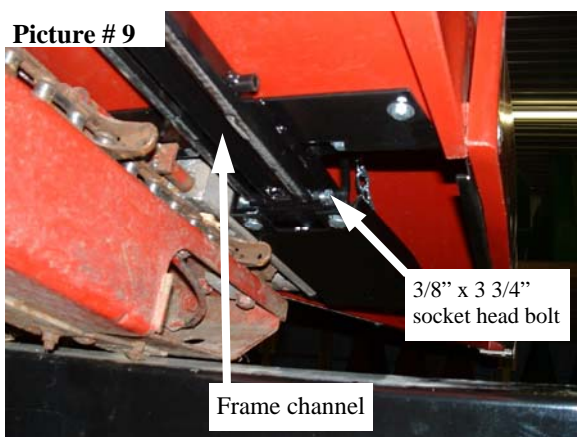
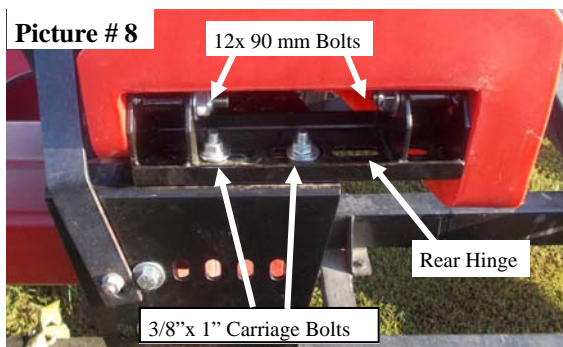
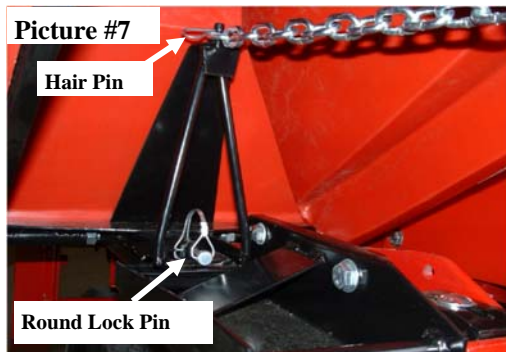

9. Place the assembled unit on the head, so that the front hold-down pin goes through the front hole on the frame and place the round lock pin through the hole in the pin. **(Picture #7)**
10. Using the two 12 x 90 mm bolts, four washers, and two 12 mm nuts, mount the poly Fender to the Hinge. **(Picture #8)**
11. Properly place the poly Fender and Rear Hinge on the Rear Hinge mount. Fasten the Rear Hinge to the Rear Hinge Mount using two 3/8" x 1" carriage bolts, washers and nuts. **(Picture #8)**
12. In the down position, install the prop rod from the under side. (T- end in the frame channel and use 3/8" x 3 3/4" socket head bolt and nylon lock nut. (Tighten the nut.) **(Picture #9)**
13. Tap the front hold down bracket forward, so the 5/8" pin is to the front of the slotted hole in the frame and tighten the 3/8" carriage bolts and nuts.
14. Remove the PVC pipe that is around the adjustment chain. (For shipping and handling only!)
15. Check and tighten all bolts and nuts.

REVISION			
REV.	DESCRIPTION	DATE	APPROVED

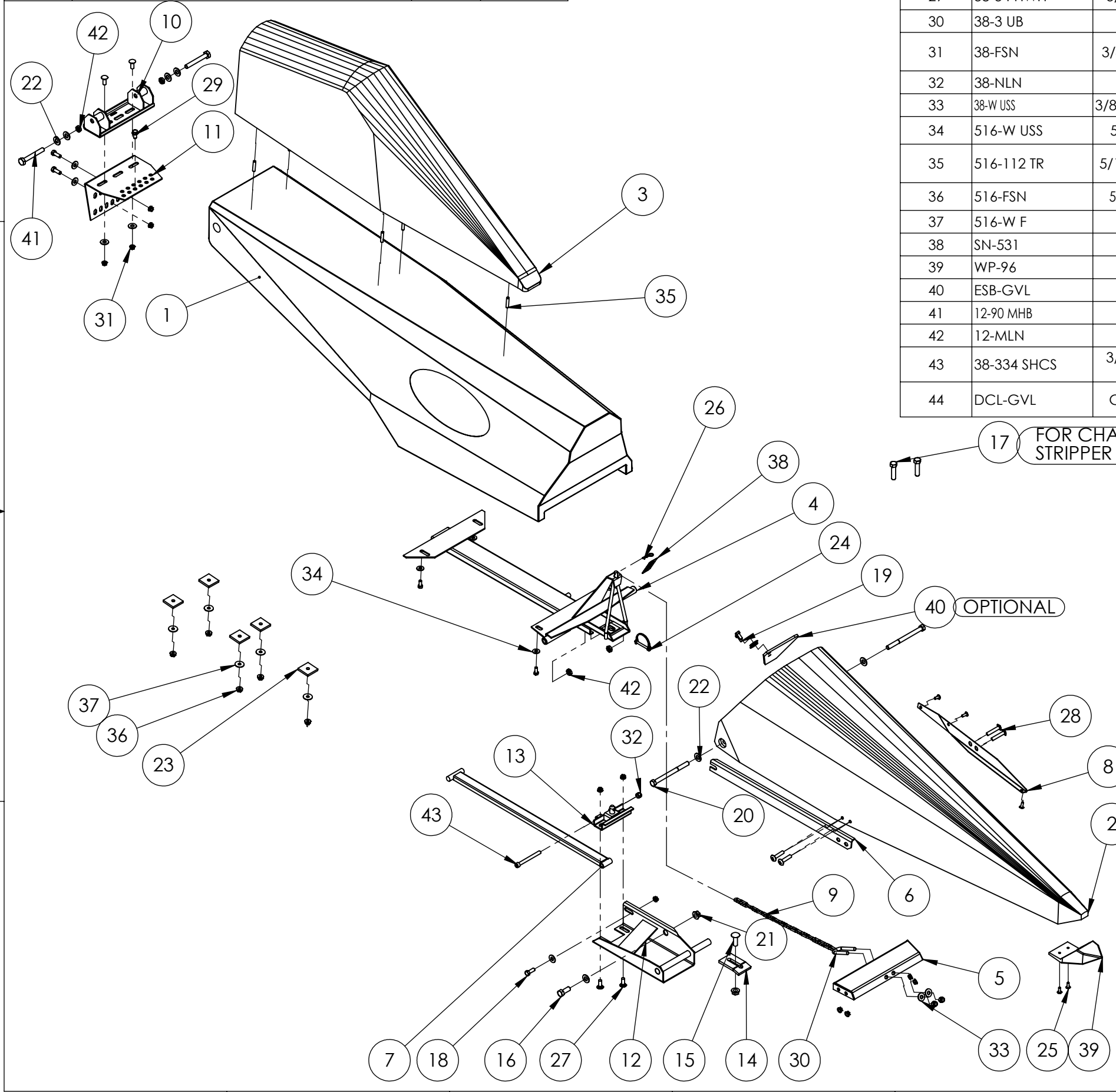

ITEM NO.	PART NUMBER	DESCRIPTION	QTY.
28	38-134 THB	3/8"x1 3/4" TRUSS HEAD BOLT	4
29	38-34 HWH	3/8"x 3/4" SELF TAP HEX HB	1
30	38-3 UB	3/8" X 3" U-BOLT	1
31	38-FSN	3/8" FLANGE SERRATED NUT	11
32	38-NLN	3/8" NYLON LOCK NUT	3
33	38-W USS	3/8" WIDE FLAT WASHER	7
34	516-W USS	5/16" WIDE FLAT WASHER	4
35	516-112 TR	5/16"x1 1/2" THREADED ROD	5
36	516-FSN	5/16" FLANGE SERRATED NUT	5
37	516-W F	5/16 FENDER WASHER	7
38	SN-531	SERIAL NUMBER TAG	1
39	WP-96	WHITE WEAR POINT	1
40	ESB-GVL	GVL EAR SAVER	1
41	12-90 MHB	M12 HEX BOLT	2
42	12-MLN	M12 TOP LOCK NUT	4
43	38-334 SHCS	3/8"X 3 3/4" SOCKET HEAD CAP SCREW	1
44	DCL-GVL	GVL MOLD ON GRAPHIC	1

ITEM NO.	PART NUMBER	DESCRIPTION	QTY.
1	RD 17702	CI 30's END RIGHT BACK LONG	1
2	RD 17700	30's RIGHT END RED	1
3	RD H 02647	HIGH END EXTENSION REF. PART ONLY	1
4	UN 16722	30's UNIVERSAL END FRAME GVLII	1
5	UN 17703	FRT ADJ GATH BRKT-30 RIGHT END	1
6	UN 00005	STIFFENER-RIGHT FRONT	1
7	UN 00007	UNIVERSAL PROP ROD	1
8	UN 21003	SS W STRIP-LEFT EDGE 30'S END	1
9	PCC-316	3/16" PROOF CHAIN 21 LINK	1
10	CI 01468	CI UNIVERSAL REAR HINGE	1
11	CI 01647	CI REAR HINGE MOUNT	1
12	CI 04732	RI FRT HOLD DN MOUNT GVLII	1
13	CI 02222	22" FRONT HOLD DOWN BRACKET	1
14	CI 00005	CI FRONT HOLD DOWN PLATE	1
15	12-112 CB	1/2"x1 1/2" CARR BOLT	1
16	12-114 HB	1/2"x1 1/4" HX HD BOLT	1
17	12-2 HB	1/2"x2" HEX HEAD BOLT	2
18	38-1 HB	3/8"x1" HX HD BOLT	3
19	516-34 HB	5/16"x3/4" HX HD BOLT	6
20	12-150 MHB	12X150MM HX HD METRIC BOLT	2
21	12-FSN	1/2" FLANGE SERRATED NUT	2
22	12-W SAE	1/2" SAE FLAT WASHER	7
23	14-134 PW	1/4"x1 3/4x1 3/4 PLASTIC	5
24	14-134 RLP	1/4"x1 3/4" ROUND LOCKING PIN	1
25	14-34 TTS	1/4"x3/4" SELF TAP SCREW	5
26	332-158 HPC	3/32"x1 5/8" HAIR PIN CLIP	1
27	38-1 CB	3/8"x1" CARR BOLT-SHORT NECK	4

UNLESS OTHERWISE SPECIFIED:
DO NOT SCALE DRAWING

DIMENSIONS ARE IN INCHES

TOLERANCES=
FRACTIONAL: +/- 1/16"
ANGULAR: +/- .5°
TWO PLACE DECIMAL: +/- .04
THREE PLACE DECIMAL: +/- .010

INTERPRET GEOMETRIC TOLERANCING PER:
MATERIAL:
FINISH:

SCALE:	NAME	DATE
DRAWN	JJN	20-Aug-13
REVISED		
VENDOR:		
VENDOR PART NO:		
PROPRIETARY AND CONFIDENTIAL		
THE INFORMATION CONTAINED IN THIS DRAWING IS THE SOLE PROPERTY OF GVL POLY. ANY REPRODUCTION IN PART OR AS A WHOLE WITHOUT THE WRITTEN PERMISSION OF GVL POLY IS PROHIBITED.		



GVL Poly
59711 US Hwy 12
Litchfield, MN 55355
www.gvlpoly.com

TITLE:
CI 900/1000 30'S RIGHT END GVL II

DWG. NO.
CI 97725

REV
0

SIZE: **B** WEIGHT: SHEET 1 OF 1

REVISION

REV.	DESCRIPTION	DATE	APPROVED

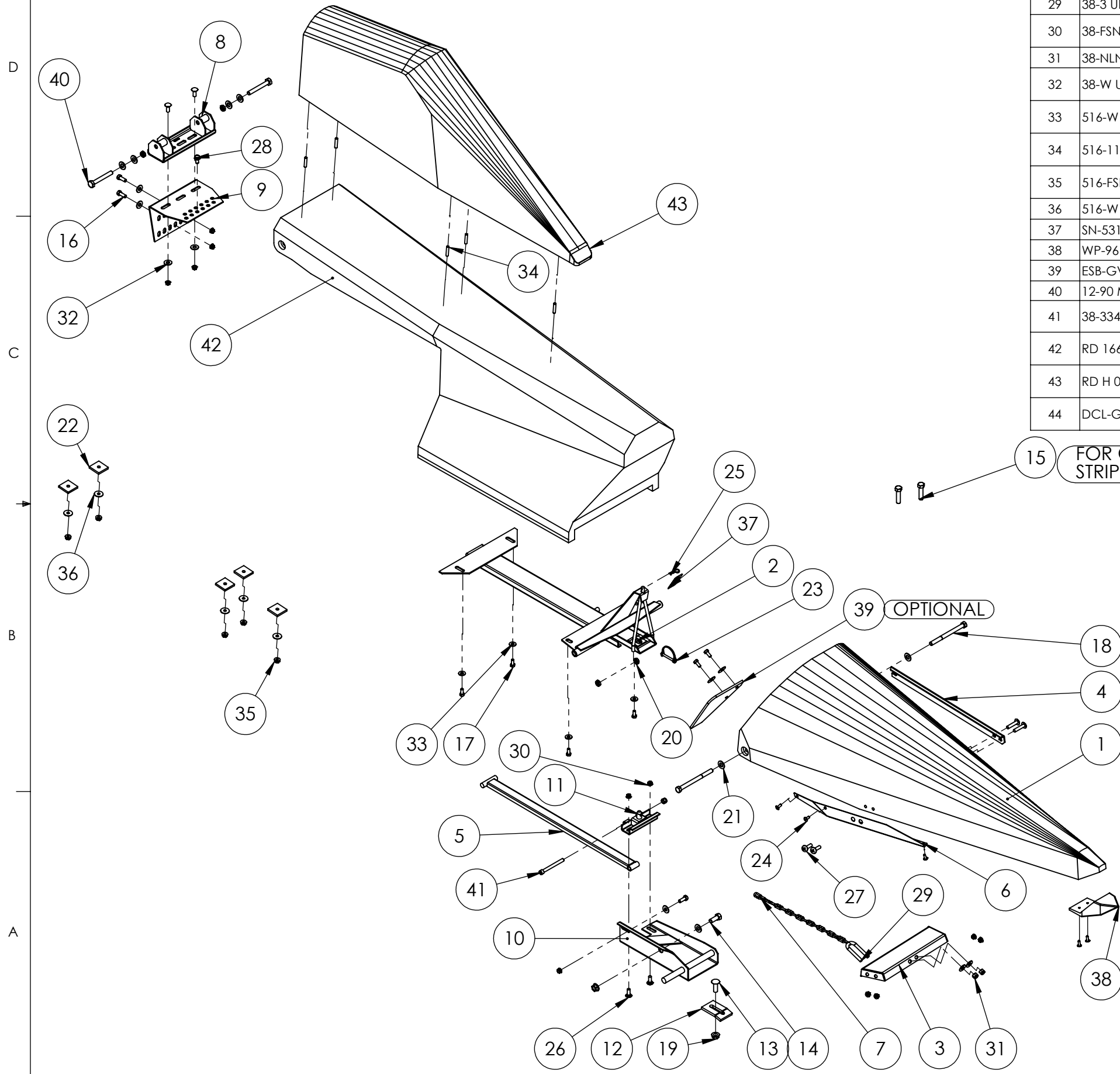

ITEM NO.	PART NUMBER	DESCRIPTION	QTY.	ITEM NO.	PART NUMBER	DESCRIPTION	QTY.
28	38-34 HWH	3/8"x 3/4" SELF TAP HEX HB	1	1	RD 16600	30's LEFT END NH YELLOW	1
29	38-3 UB	3/8" X 3" U-BOLT	1	2	UN 16722	30's UNIVERSAL END FRAME GVLII	1
30	38-FSN	3/8" FLANGE SERRATED NUT	11	3	UN 16603	FRT ADJ GATH BRKT-30 LEFT END	1
31	38-NLN	3/8" NYLON LOCK NUT	3	4	UN 00004	STIFFENER-LEFT FRONT	1
32	38-W USS	3/8" WIDE FLAT WASHER	7	5	UN 00007	UNIVERSAL PROP ROD	1
33	516-W USS	5/16" WIDE FLAT WASHER	4	6	UN 21004	SS W STRIP-RIGHT EDGE 30'S END	1
34	516-112 TR	5/16"x1 1/2" THREADED ROD	5	7	PCC-316	3/16" PROOF CHAIN 21 LINK	1
35	516-FSN	5/16" FLANGE SERRATED NUT	5	8	CI 01468	CI UNIVERSAL REAR HINGE	1
36	516-W F	5/16 FENDER WASHER	7	9	CI 01647	CI REAR HINGE MOUNT	1
37	SN-531	SERIAL NUMBER TAG	1	10	CI 01632	LE FRT HOLD DN MOUNT GVLII	1
38	WP-96	WHITE WEAR POINT	1	11	CI 02222	22" FRONT HOLD DOWN BRACKET	1
39	ESB-GVL	GVL EAR SAVER	1	12	CI 00005	CI FRONT HOLD DOWN PLATE	1
40	12-90 MHB	M12 HEX BOLT	2	13	12-112 CB	1/2"x1 1/2" CARR BOLT	1
41	38-334 SHCS	3/8"x 3 3/4" SOCKET HEAD CAP SCREW	1	14	12-114 HB	1/2"x1 1/4" HX HD BOLT	1
42	RD 16602	CI 30's END LEFT BACK LONG	1	15	12-2 HB	1/2"x2" HEX HEAD BOLT	2
43	RD H 02647	HIGH END EXTENSION REF. PART ONLY	1	16	38-1 HB	3/8"x1" HX HD BOLT	3
44	DCL-GVL	GVL MOLD ON GRAPHIC	1	17	516-34 HB	5/16"x3/4" HX HD BOLT	6
				18	12-150 MHB	12X150MM HX HD METRIC BOLT	2
				19	12-FSN	1/2" FLANGE SERRATED NUT	2
				20	12-MLN	M12 TOP LOCK NUT	4
				21	12-W SAE	1/2" SAE FLAT WASHER	7
				22	14-134 PW	1/4"x1 3/4x1 3/4 PLASTIC	5
				23	14-134 RLP	1/4"x1 3/4" ROUND LOCKING PIN	1
				24	14-34 TTS	1/4"x3/4" SELF TAP SCREW	5
				25	332-158 HPC	3/32"x1 5/8" HAIR PIN CLIP	1
				26	38-1 CB	3/8"x1" CARR BOLT-SHORT NECK	4
				27	38-134 THB	3/8"x1 3/4" TRUSS HEAD BOLT	4

UNLESS OTHERWISE SPECIFIED:
DO NOT SCALE DRAWING

DIMENSIONS ARE IN INCHES

TOLERANCES=
FRACTIONAL: $\pm 1/16"$
ANGULAR: $\pm .5^\circ$
TWO PLACE DECIMAL: $\pm .04$
THREE PLACE DECIMAL: $\pm .010$

INTERPRET GEOMETRIC TOLERANCING PER:
MATERIAL:
FINISH:

SCALE:

NAME	DATE
JJN	20-Aug-13

REVISOR:

VENDOR:

VENDOR PART NO:

PROPRIETARY AND CONFIDENTIAL

THE INFORMATION CONTAINED IN THIS DRAWING IS THE SOLE PROPERTY OF GVL POLY. ANY REPRODUCTION IN PART OR AS A WHOLE WITHOUT THE WRITTEN PERMISSION OF GVL POLY IS PROHIBITED.

GVL Poly
59711 US Hwy 12
Litchfield, MN 55355
www.gvlpoly.com

TITLE:
CI 900/1000 30'S LEFT END GVL II

DWG. NO.
CI 96625

REV
0

SIZE: **B** WEIGHT: SHEET 1 OF 1