

## DU-HA Humpstor (Topper & Caps)

### Tools Needed:

- // Hex Key Wrench 1/8"                      // Wrench or Socket - 3/8"
- // 2 Open-End Wrenches - 1/2"           // Wrench or Socket - 7/16"
- // Socket - 1/2"                               // Wrench or Socket 9/16"

## Installation Instructions:

### STEP 1 - Attach Handle

Place Handle (B) over holes in Lid Top. Insert two Bolts #10 x 1" (M) through Handle (B), Flat Washer - #10 (N) and Humpstor Lid (A). Secure with Flat Washer - #10 (N) and Lock Nut #10 (O) Use 1/8" Hex Key Wrench. Note: Handle may already be installed.

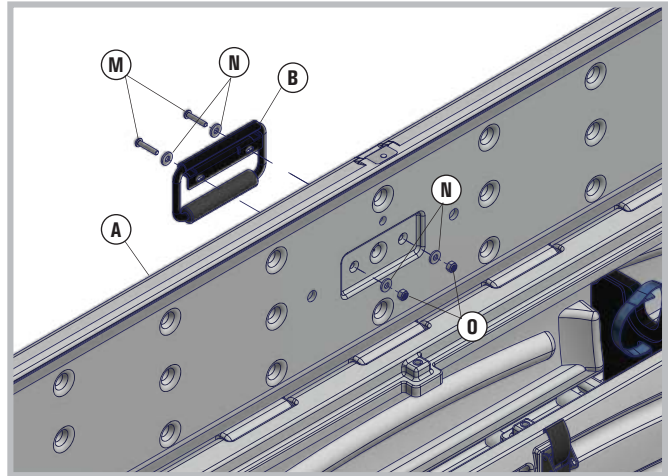

### STEP 2 - Attach Support Angle

Attach Humpstor Support Angle (AD) to the bottom of the Humpstor (A). The Humpstor Support Angle can be attached to either side on the bottom of the Humpstor (A). It works best if it is positioned on the opposite side of where the Humpstor Support Brackets (E) attach to the bed rail of the truck. Attach the Humpstor Support Angle (AD) to the bottom of the Humpstor (A) using two Spacers - 3/8" (AC) positioned in between the Humpstor (A) and the Humpstor Support Angle (AD) secure using Hex Bolt - 1/4 x 1 (AB), 1/4 - Washer (S) and 1/4 Lock Washer (T) on each end of Humpstor (A), leave bolts loose until you attach the Humpstor Support Brackets (E).

NOTE: Make sure the slots in the middle of the Humpstor Support Angle (AD) line up with the inserts in the middle of the bottom of the Humpstor (A).

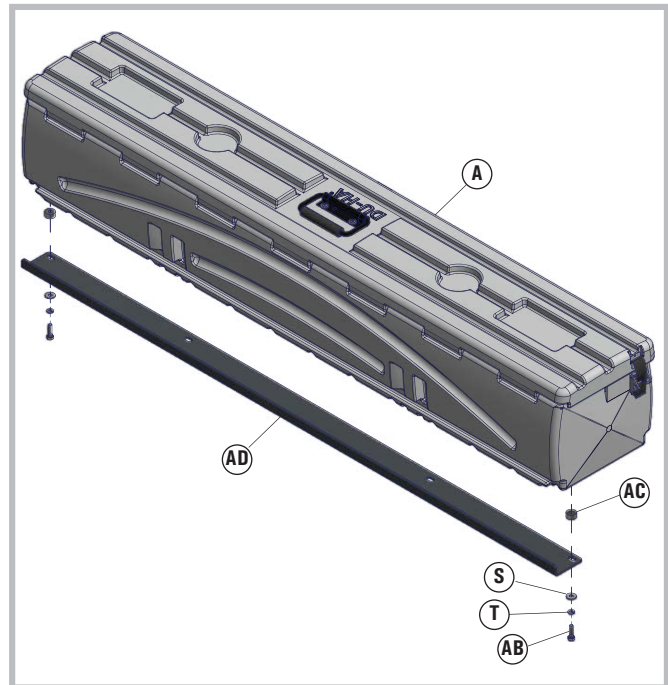

### STEP 3 - Assemble Rail Clamps

Assemble Topper Clamp set (F) by sliding A and B parts of the clamps together and insert the Hex Bolt 3/8" x 3-1/2" (Y) through the top hole on part B and thread into threaded hole on part A. Leave clamp loose so you can slide it onto the rail of the truck.

Note: If you are using the optional Toyota / Nissan Installation Kit or the optional Open Bed / Tonneau Installation Kit refer to those installation instructions.

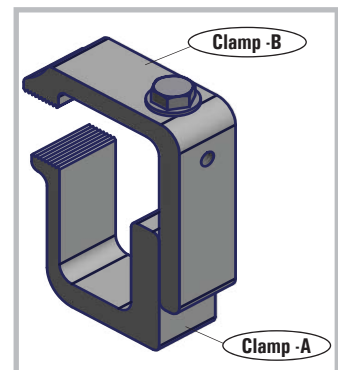
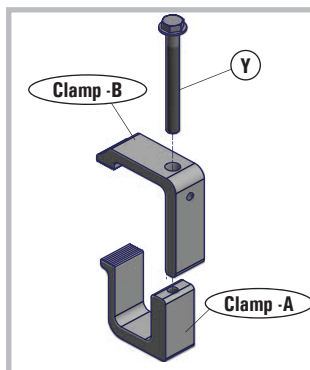

## STEP 4 - Attach Stabilizer Foot

### Install Stabilizer Foot

Attach one Stabilizer Foot (I) to Support Brackets (E) by threading one Flange Nut - 5/16" (P) onto Stabilizer Foot (I) shaft and insert through the lower hole of each Bracket or slot above bottom hole. Thread a second Flange Nut (P) onto Stabilizer Foot (I) shaft sandwiching the Bracket in between.

Hint: Flanged side of nuts should face Bracket.

Note: Finger tighten.

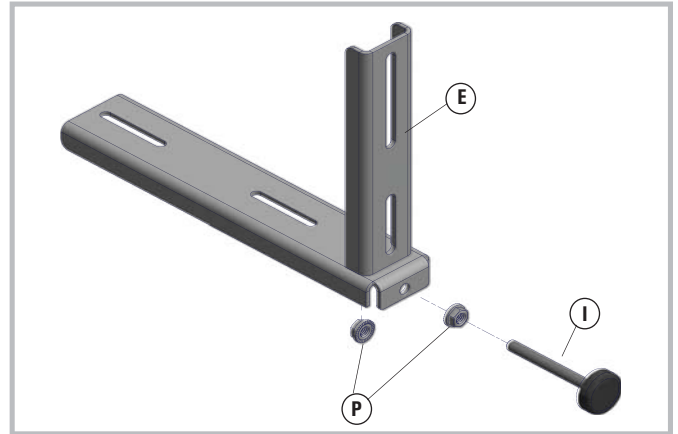

### Extended Stabilizer Foot

Some installations require a longer Stabilizer Foot (I) (Toyota Tundra for example). In such cases, prior to installing the Stabilizer Foot (I), attach one Hex bolt - 5/16" x 2" (U) and Coupling Nut - 5/16" (X) to each Stabilizer Foot (I).

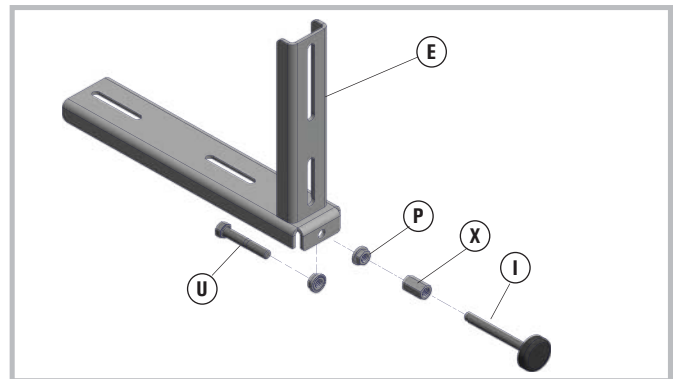

## STEP 5 - Assemble Brackets

### Option I - Topper or Open Bed Mount

Use this option for most standard installations for open truck beds or for use with toppers. No additional Drop Down Plates (G) required. Use the standard Support Brackets (E).

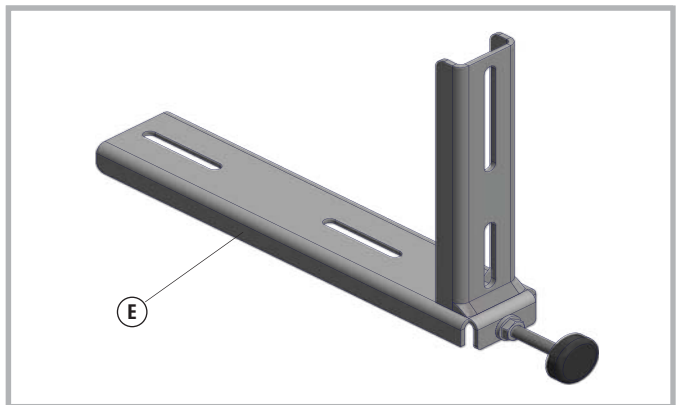

### Option II - If you want the Humpstor to sit lower

Attach Drop-Down Plate (G) to Support Brackets (E) with two Carriage Bolts - 5/16" x 3/4" (L), two Flat Washers 5/16" (V) and two Lock Nuts 5/16" (W).

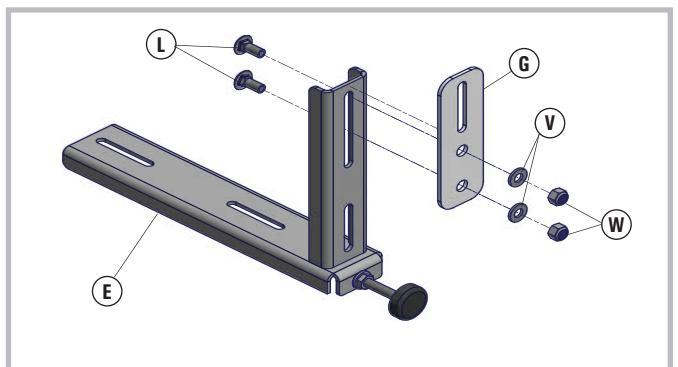

## STEP 6 - Attach Topper Clamps to Truck

Look at your bed rail to determine where to attach your Topper clamps, find locations where you can attach the clamps at the below spacing and still have room to operate the end latches on the Humpstor. Attach Topper Clamps (F) to truck bed rail by sliding clamps onto truck bed rail from the top and the bottom of the rail, slide onto rail as far as possible. Secure to rail by tightening Bolt  $3/8" \times 3-1/2"$  (Y) tighten firmly with  $9/16"$  Wrench, make sure to keep clamps straight and position at 24" center to center.

*Optional Installation Kit:* You can also use the provided  $5/16"$  rectangular nuts (AA) to attach the support brackets (E) to the factory Toyota or Nissan nut rails. Slide the provided  $5/16"$  rectangular nuts (AA) into the factory accessory nut rail, position 24" apart so you can attach the support brackets. Use  $5/16 \times 1$  hex bolts (K),  $5/16$  lock washers (W) and flat washers (V) to attach the support brackets to the rectangular nuts (AA) installed in the factory accessory rail.

## STEP 7 - Attach Brackets to Topper Clamps

Attach Support Brackets (E) to Topper Clamps (F) using Hex Bolt  $5/16" \times 3/4"$  (Q), Flat Washer  $5/16"$  (V), Lock Washer  $5/16"$  (Z), using one per Topper Clamp set (F), thread into hole in Topper Clamp, as shown below in view (a). Determine where you want the top of the Humpstor to be positioned and position the support brackets (E) 10" below that position to the bottom of the brackets (E) where the Humpstor sits, as shown below in view (b).

Level bracket assembly by adjusting each Stabilizer Foot (I) to contact the side of the truck box, try to have Stabilizer Foot contact a flat surface.

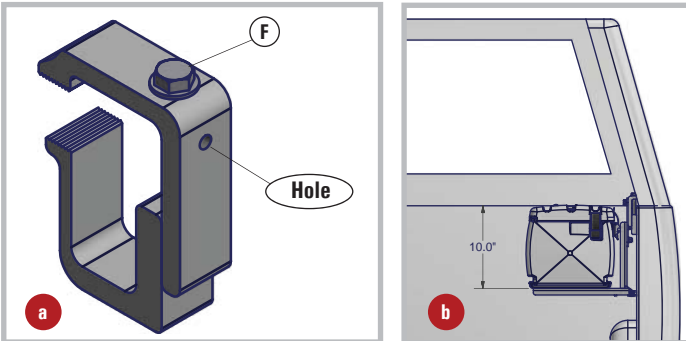

## STEP 8 - Attach Humpstor to Brackets

### Humpstor Positions

The Humpstor can be mounted with the lid opening toward the inside of the truck bed (a) or with the lid opening toward the outside of the truck bed (b). The assembly steps and hardware are the same other than the orientation of the Humpstor.

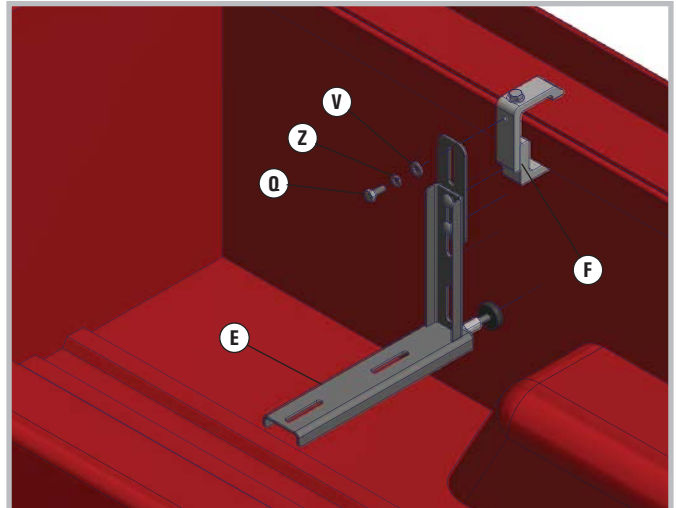
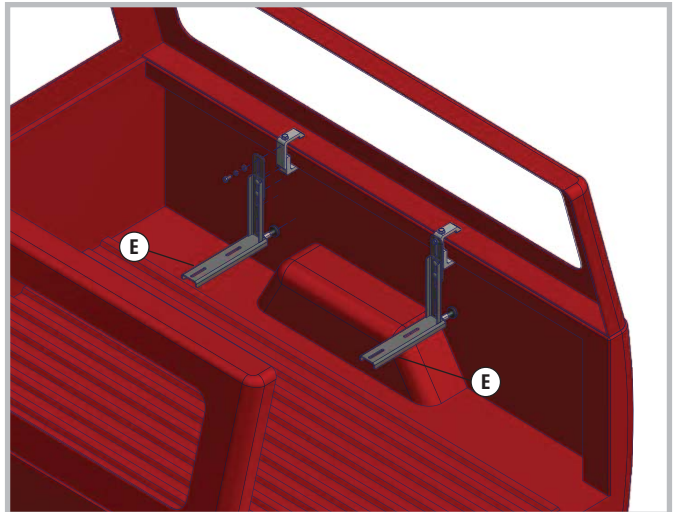
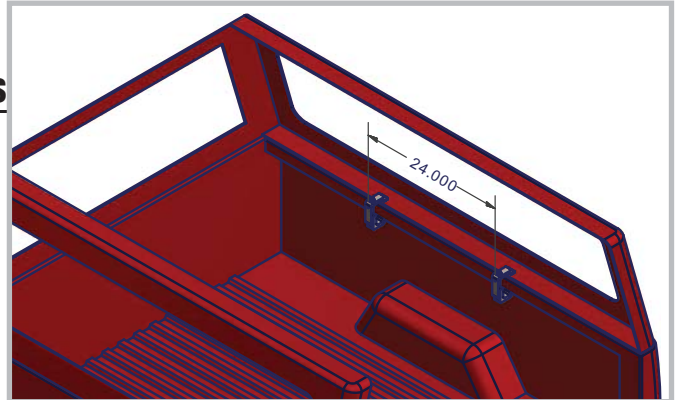
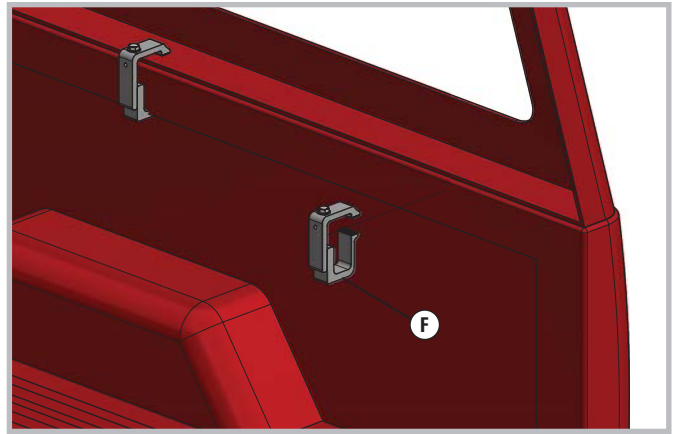
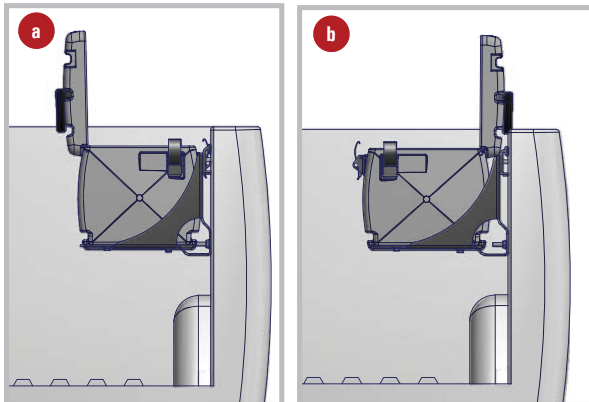

### Humpstor Attachment

Place the Humpstor (A) onto the Support Brackets. Thread one Hex Bolt - 1/4" x 5/8" (R), Lock Washer - 1/4" (T) and Flat Washer 1/4" (S) through bottom slots of the Support Brackets (E), through the slot in the Humpstor Support Angle (AD) and into the threaded holes in the bottom of the Humpstor, located below the slots for the Foam Organizer / Gun Holder (as shown). After you tighten the bolts through the previously installed bolts on the Humpstor Support Angle (AD).

### Humpstor Adjustment

Slide Humpstor in or out to desired position. For example, in a roll-up cover the Humpstor should be slid away from the side rail of the truck bed to allow the lid to open; for open-bed, the Humpstor should be as close as possible to the bed rail of the truck.

To adjust the Humpstor vertically loosen the Clamp Bracket hex bolt 5/16" x 3/4" (Q). Slide the Brackets up/down as needed along the slot in the Brackets or Drop-Down Plates. Make sure Humpstor is level, then tighten all hardware connections.

Note: Humpstor should be adjusted as high and as close to the rail as possible while still allowing the lid to open properly.

## STEP 9 - Install Organizer / Gun Holders

### Foam Organizer / Gun Holders / Stiffeners

Sandwich each Foam Organizer / Gun Holder (C) in between two Plastic Stiffeners (D). Place each Foam Organizer / Gun Holder / Stiffener assembly into the channel slots in the side walls of the Humpstor (A), facing opposing directions.

Note: You may have to flex the assembly to get it into place. (Hint – Stock of gun should rest in large groove; barrel should rest in small groove.)

### Velcro Straps

To secure guns in the Humpstor, loop each Velcro Strap (J) through the holes in the top of the Foam Organizer / Gun Rack (C) / Stiffener (D) assembly. Wrap the Velcro Strap around the gun, then attach the Velcro Strap to itself and make sure it is securely fastened.

Note: Proper use of Velcro Straps helps prevent guns from bouncing on rough terrain.

### Center Brace

To maximize strength and stability, use the Center Brace (H). Insert each end into the hole on the top lip of the Humpstor (A) at the middle. To access cargo while using the Center Brace, lift one end out of the hole and rotate the Center Brace out of the way. Return Center Brace to hole when finished.

### Locking the Humpstor

To lock Humpstor, use one or more standard padlocks. Insert lock through the latch hole.

Note: Lock only needs to go through one hole in the latch.

Note: The Middle Latch does not need to be latched to secure lid.

Note: Lid may need to be pressed down in order to close the latches when the seal is new. Once the seal has formed to the lid it should close on its own.

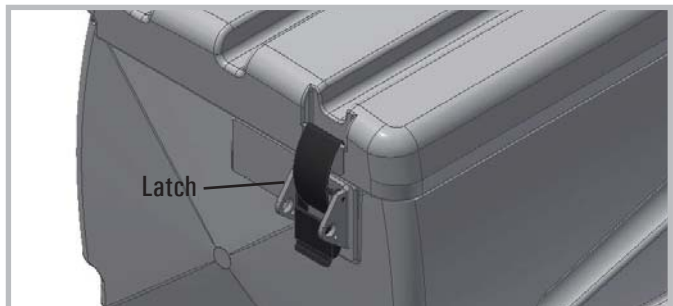
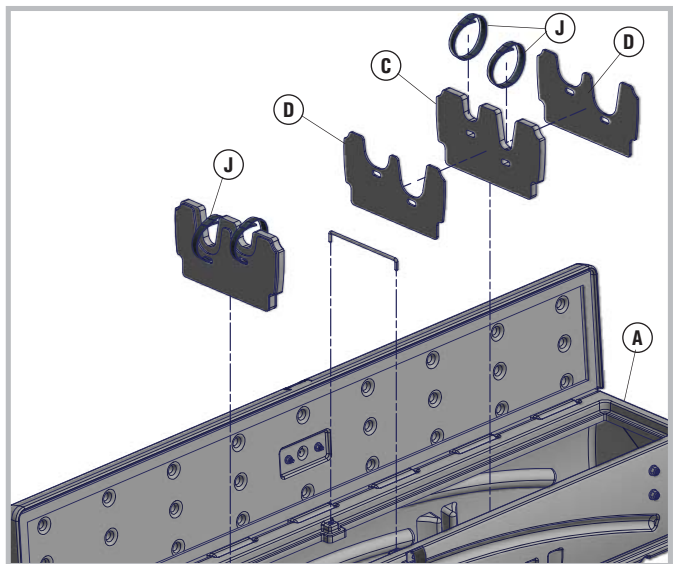
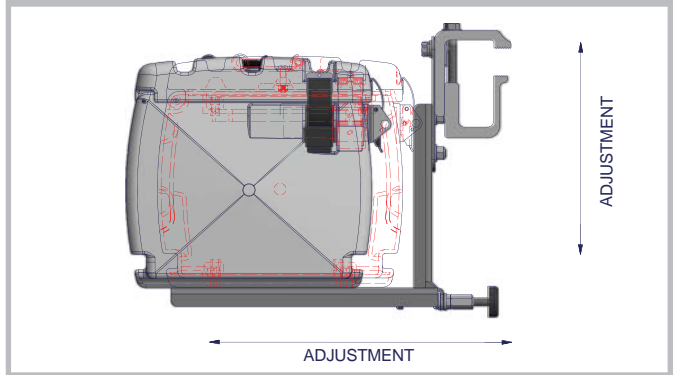
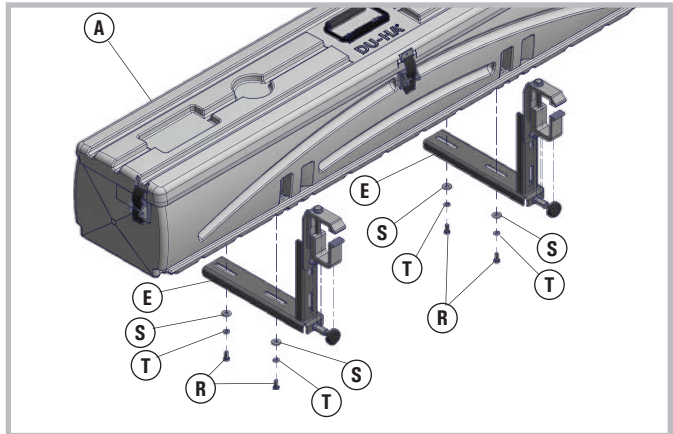

### Safety Instructions:

**Warning: 75 LBS CAPACITY – DO NOT EXCEED 75 POUNDS OF CARGO IN THE HUMPSTOR. CAUTION – Do not store explosives or hazardous materials in the HUMPSTOR. Do not place loaded guns in the HUMPSTOR. For further instructions refer to the vehicle owners manual or contact DU-HA, Inc.**

# Exploded View / Parts List

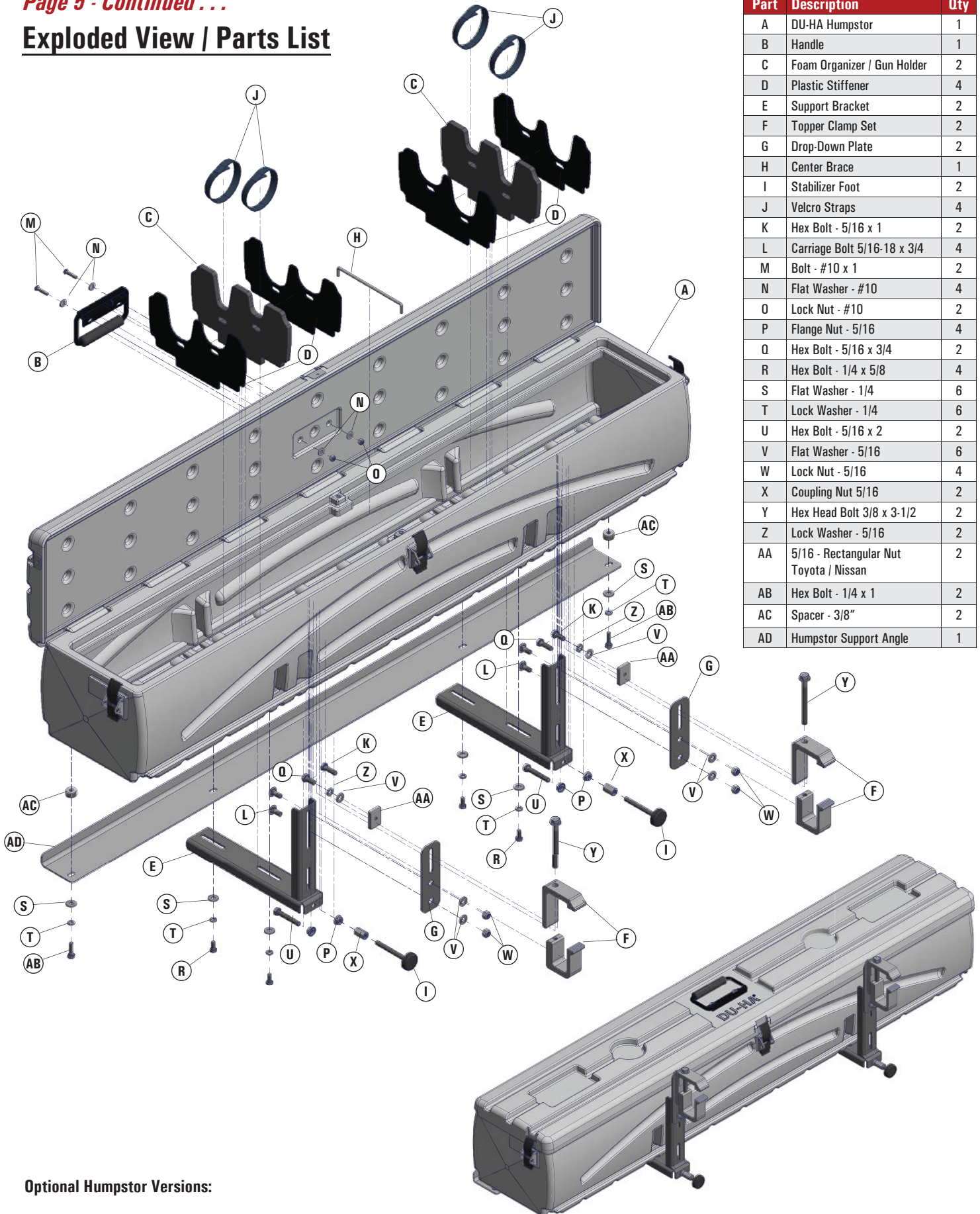

Part	Description	Qty
A	DU-HA Humpstor	1
B	Handle	1
C	Foam Organizer / Gun Holder	2
D	Plastic Stiffener	4
E	Support Bracket	2
F	Topper Clamp Set	2
G	Drop-Down Plate	2
H	Center Brace	1
I	Stabilizer Foot	2
J	Velcro Straps	4
K	Hex Bolt - 5/16 x 1	2
L	Carriage Bolt 5/16-18 x 3/4	4
M	Bolt - #10 x 1	2
N	Flat Washer - #10	4
O	Lock Nut - #10	2
P	Flange Nut - 5/16	4
Q	Hex Bolt - 5/16 x 3/4	2
R	Hex Bolt - 1/4 x 5/8	4
S	Flat Washer - 1/4	6
T	Lock Washer - 1/4	6
U	Hex Bolt - 5/16 x 2	2
V	Flat Washer - 5/16	6
W	Lock Nut - 5/16	4
X	Coupling Nut 5/16	2
Y	Hex Head Bolt 3/8 x 3-1/2	2
Z	Lock Washer - 5/16	2
AA	5/16 - Rectangular Nut Toyota / Nissan	2
AB	Hex Bolt - 1/4 x 1	2
AC	Spacer - 3/8"	2
AD	Humpstor Support Angle	1

**Optional Humpstor Versions:**

70200 - DU-HA Humpstor - Truck Bed Storage (Open Bed or Tonneau Cover)

**Note:** You may have extra parts leftover, depending on your trucks installation option.