

CASE IH 2600/4200/4400 SERIES - NEW HOLLAND 99C/980 SERIES QD2 STALK STOMPER PARTS LISTING/ASSEMBLY INSTRUCTIONS

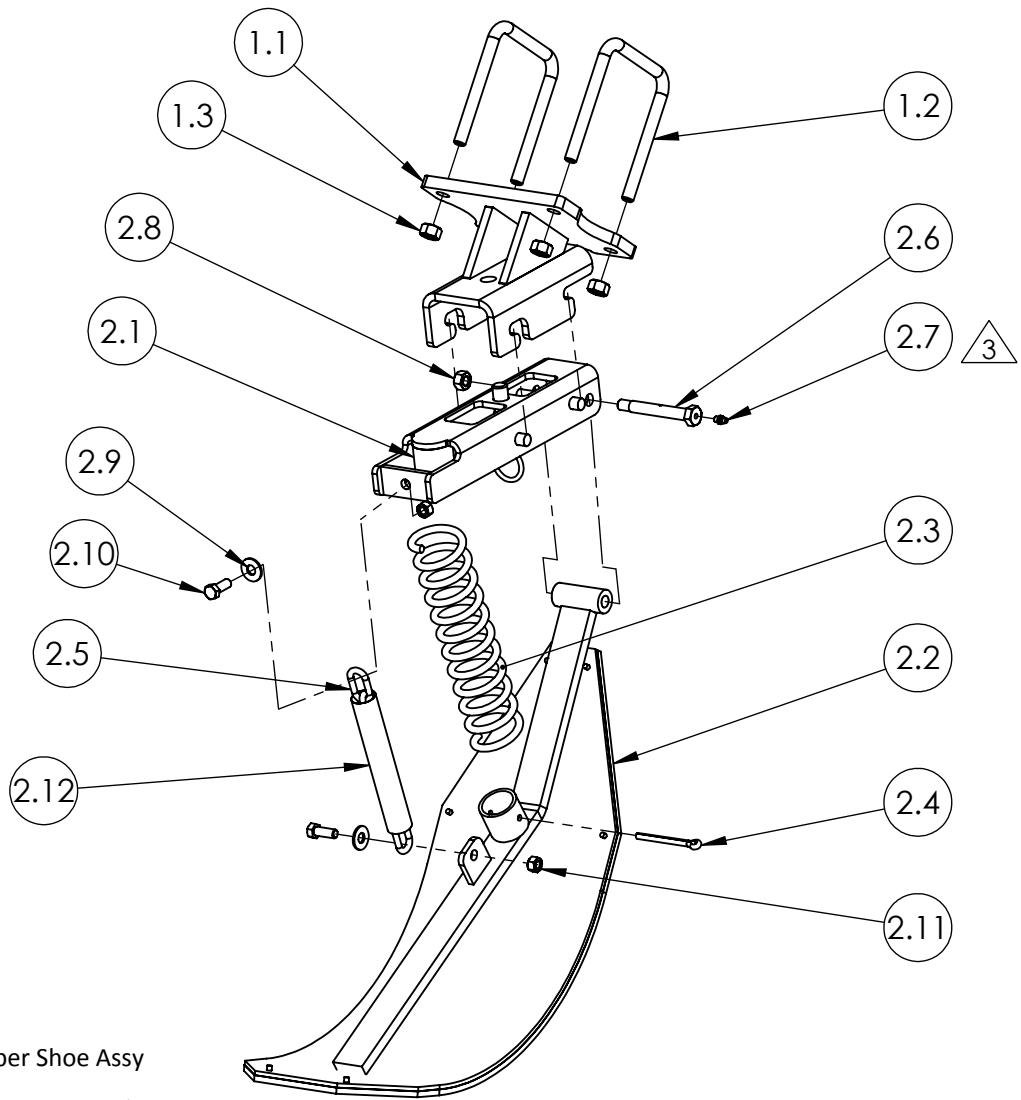

NOTES:

- ① 43016 - 14" Stalk Stomper Shoe Assy
- ② 41748 - 14" Stalk Stomper Shoe W/Poly
- ③ Install Self-Tapping Grease Fitting into end of Pivot Bolt
Torque grease fitting to 65-70 inch pounds. DO NOT OVERTIGHTEN!

ITEM #	PART #	DESCRIPTION	QTY	ITEM #	PART #	DESCRIPTION	QTY
1	43006	QD2 HEADER BRACKET ASSY	1	2.5	00931	CHAIN	1
1.1	43007	QD2 HEADER BRACKET	1	2.6	01001	BOLT, CUSTOM (GREASEABLE)	1
1.2	00965	U-BOLT 1/2-13	2	2.7	01009	GREASE FITTING, 1/4"-28 STRAIGHT	1
1.3	00216	NUT, 1/2"-13 TOP LOCK	4	2.8	00213	NUT, 7/16"-14 HEX TOP LOCK	1
① 2	43003	STALK STOMPER ASSY 9"	1	2.9	00249	WASHER, 3/8" FLAT	2
2.1	43004	SHOE BRACKET ASSY	1	2.10	00104	BOLT, 3/8"-16 X 1" HEX	2
② 2.2	41825	STALK STOMPER SHOE W/POLY 9"	1	2.11	00209	NUT, 3/8"-16 HEX	2
2.3	01040	SPRING	1	2.12	01046	CHAIN SLEEVE	1
2.4	00691	PIN, 1/4" X 3" COTTER	1				



120 Eastgate Drive SE
PO Box 7
Hutchinson, MN 55350

1-800-788-6483
1-320-587-2322
1-320-587-6112 (Fax)

WWW.MAYWES.COM

CASE IH 2600/4200/4400 SERIES - NEW HOLLAND 99C/980 SERIES

STALK STOMPER INSTALLATION

Safety Procedure:

- Park combine on level ground and lock the brakes.
- Raise the head and lock in the upright position.

Installation Procedure:

- Remove the factory metal shield above the 4X4 frame beam on rows that stalk stompers are being installed.
- Place U-Bolts over the top of the 4X4 frame beam (as shown).
- Place the Header Bracket (43007) below the 4X4 frame beam on center with the row unit positioning the "hook slots" toward the rear of the head. Align the U-Bolts with Header Bracket and secure in place with the 1/2" top lock nuts, clamping the frame beam.
- Lift the Stalk Stomper Assy (43003) into mating features in the Header Bracket (43007). Pull Stalk Stomper Assy back until lock pin snaps into place.
- Replace the factory metal shield.

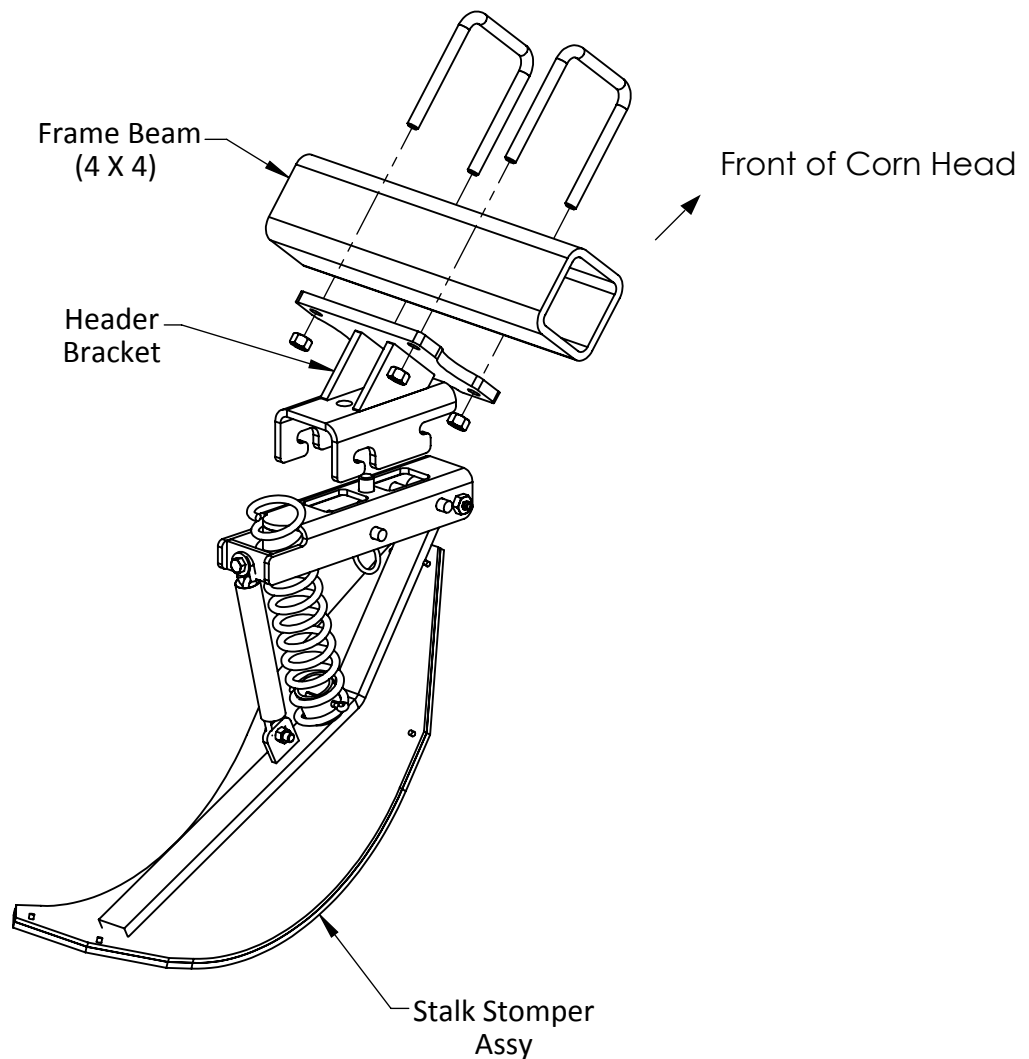

120 Eastgate Drive SE
PO Box 7
Hutchinson, MN 55350

1-800-788-6483
1-320-587-2322
1-320-587-6112 (Fax)

WWW.MAYWES.COM