

CASE IH 2600/4400 SERIES - NEW HOLLAND 99C/980 SERIES

ROWS 2 & 5 ON 2600 AND 99C SIX ROW HEADS
 ROWS 2 & 11 ON 4400 AND 980 TWELVE ROW FOLDING HEADS
 STALK STOMPER PARTS LISTING/ASSEMBLY INSTRUCTIONS

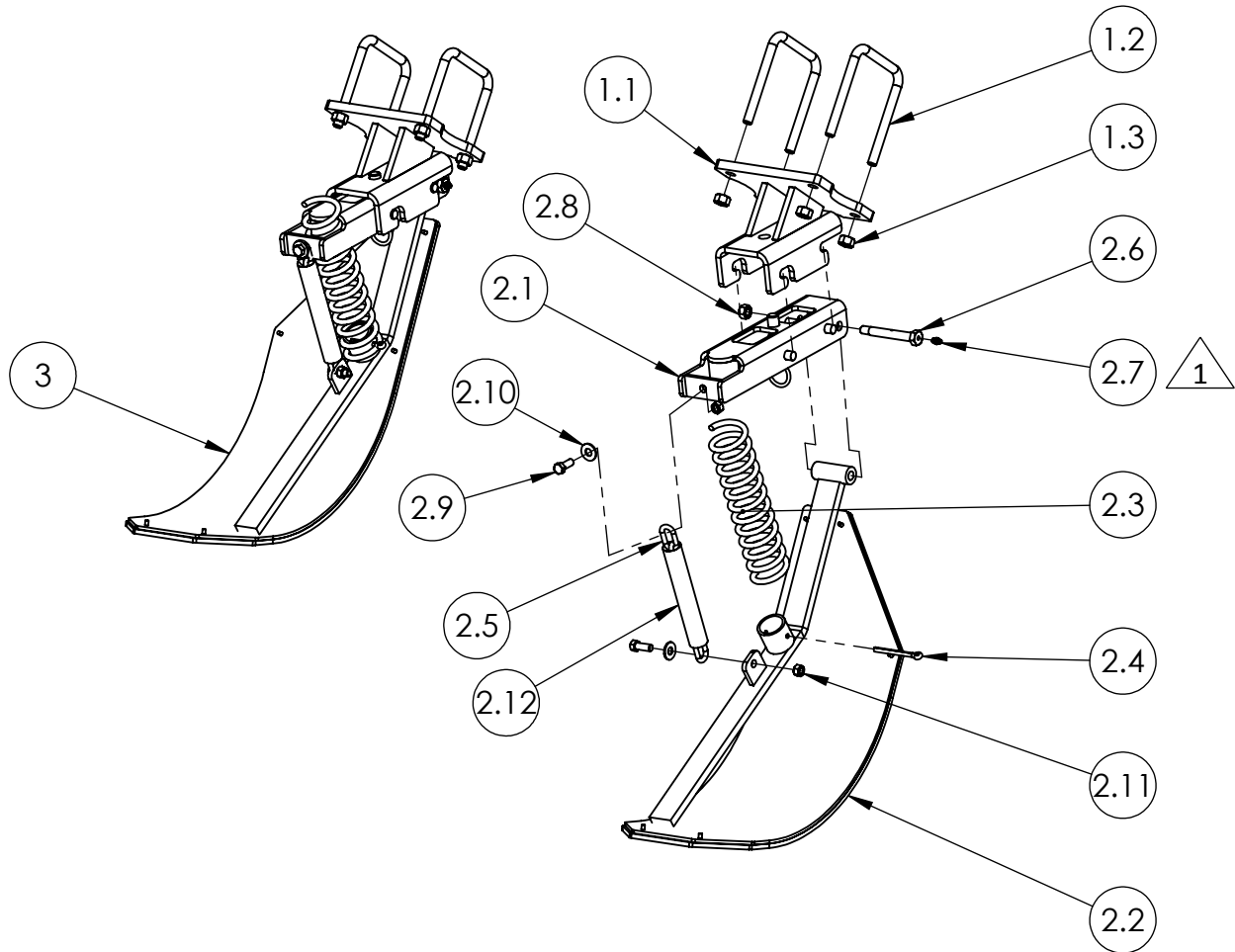

NOTES:

1 Install Self-Tapping Grease Fitting into end of Pivot Bolt
 Torque grease fitting to 65-70 inch pounds. **DO NOT OVERTIGHTEN!**

ITEM #	PART #	DESCRIPTION	QTY	ITEM #	PART #	DESCRIPTION	QTY
1	43006	QD2 HEADER BRACKET ASSY	2	2.5	00931	CHAIN	1
1.1	43007	QD2 HEADER BRACKET	1	2.6	01001	BOLT, CUSTOM (GREASEABLE)	1
1.2	00965	U-BOLT 1/2-13	2	2.7	01009	GREASE FITTING, 1/4"-28 STRAIGHT	1
1.3	00216	NUT, 1/2"-13 TOP LOCK	4	2.8	00213	NUT, 7/16"-14 HEX TOP LOCK	1
2	43014	OFFSET LEFT SS ASSY 9"	1	2.9	00104	BOLT, 3/8"-16 X 1" HEX	2
2.1	43004	SHOE BRACKET ASSY	1	2.10	00249	WASHER, 3/8" FLAT	2
2.2	41856	OFFSET LEFT STALK STOMPER	1	2.11	00209	NUT, 3/8"-16 HEX	2
2.3	01040	SPRING	1	2.12	01046	CHAIN SLEEVE	1
2.4	00691	PIN, 1/4" X 3" COTTER	1	3	43013	OFFSET RIGHT SS ASSY 9"	1



**120 Eastgate Drive SE
 PO Box 7
 Hutchinson, MN 55350**

**1-800-788-6483
 1-320-587-2322
 1-320-587-6112 (Fax)**

WWW.MAYWES.COM

CASE IH 2600/4400 SERIES - NEW HOLLAND 99C/980 SERIES

ROWS 2 & 5 ON 2600 AND 99C SIX ROW HEADS

ROWS 2 & 11 ON 4400 AND 980 TWELVE ROW FOLDING HEADS

STALK STOMPER PARTS LISTING/ASSEMBLY INSTRUCTIONS

Safety Procedure:

- Park combine on level ground and lock the brakes.
- Raise the head and lock in the upright position.

Installation Procedure:

- Remove the factory metal shield above the 4X4 frame beam on rows that stalk stompers are being installed.
- Place U-Bolts over the top of the 4X4 frame beam.
- Place the Header Bracket (43007) below the 4X4 frame beam and to the inside of the sub frame as close to row center as possible positioning the "hook slots" toward the rear of the head. Align the U-Bolts with Header Bracket and secure in place with the 1/2" top lock nuts, clamping the frame beam.
- Lift the Stalk Stomper Assy (43013/43014) into mating features in the Header Bracket (43007)
Pull Stalk Stomper Assy back until lock pin snaps into place.
- Replace the factory metal shield.

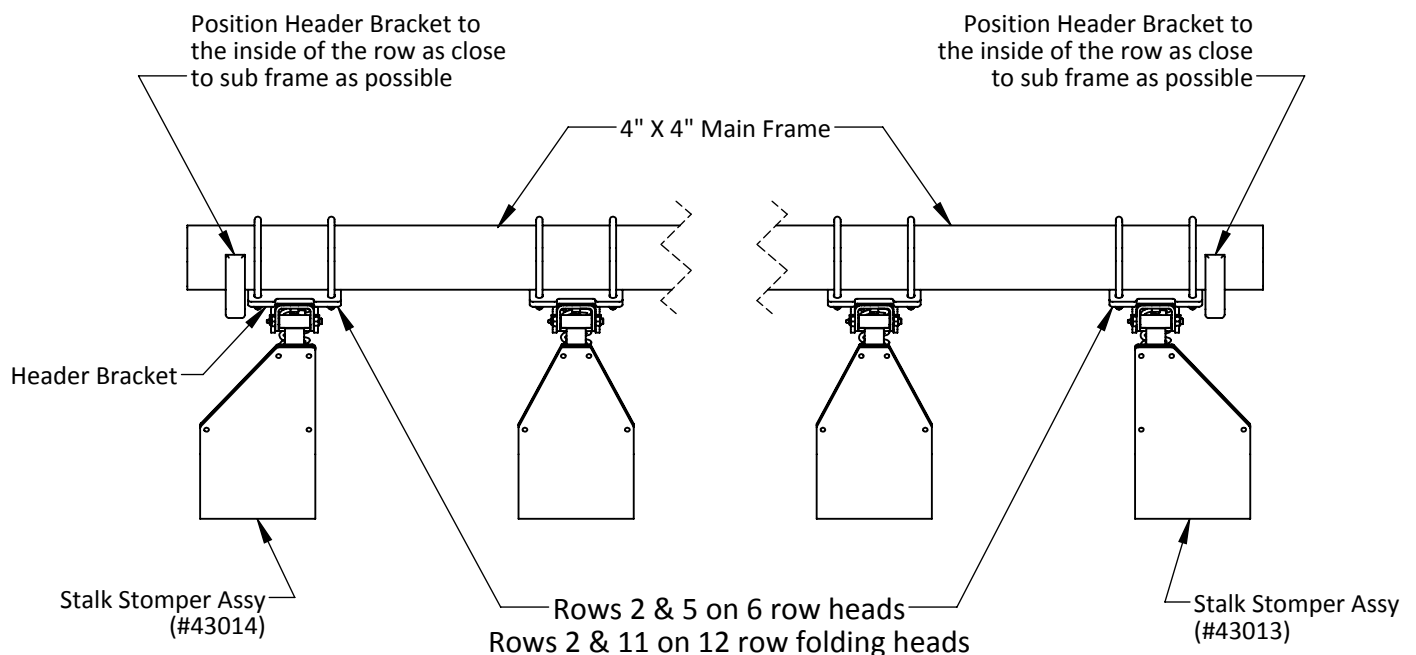

As looking from the front of the Corn Head



120 Eastgate Drive SE
PO Box 7
Hutchinson, MN 55350

1-800-788-6483
1-320-587-2322
1-320-587-6112 (Fax)

WWW.MAYWES.COM