

# G4 Tractor Stalk Stomper Instructions

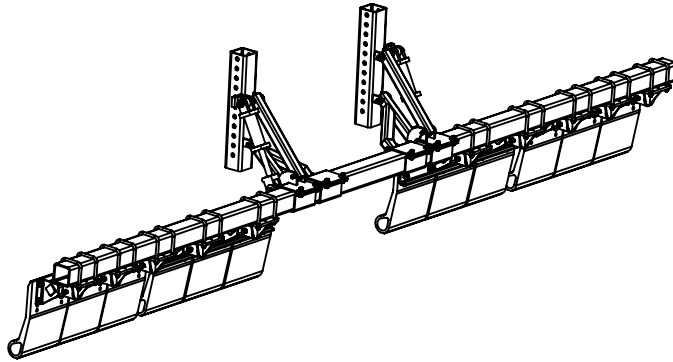

## CAUTION

PLEASE REFER TO YOUR EQUIPMENT  
MANUFACTURER'S OPERATORS MANUAL  
FOR PERTINENT SAFETY PRECAUTIONS



## Important

READ ALL INSTRUCTIONS  
BEFORE STARTING  
INSTALLATION

### Setup/Operating Recommendations:

May Wes G4 Tractor Stalk Stompers are intended to be setup/operated with minimal ground contact.

- Park Tractor on flat and level ground and lock the Brakes.
- Assemble the mounting bracket to the tractor frame. (See your individual mounting instructions)
- Assemble the vertical tubes, lifting arms, cylinders and cross tube. (Pages 2-4)
- Assemble Shoes to the tube. (Page 5)
- Adjust shoes to be just touching the ground to 1" off of the ground when lowered in the operating position.

Note: As with all aftermarket product applications please maintain an awareness of the Stalk Stompers during operation. The Stalk Stompers should always be raised prior to backing up to prevent damage to the Stalk Stompers. The design of the shoe and dual action torsion unit is intended to prevent or minimize damage if stalk stompers are inadvertently left down while backing up.

### Maintenance Recommendations:

Your May Wes Tractor Stalk Stompers should require minimal maintenance during operation. During routine equipment maintenance, clean and check the bolts and bushings connecting lift arms and replace when wear is present.

The shoes and torsion units should also be checked periodically for proper adjustment/operation and to ensure that the torsion units flex freely. This should be done along with other routine maintenance of the equipment.

### Storage Recommendations:

Stalk Stompers can not be stored directly on the shoe. It is recommended that stalk stompers be removed prior to removal from the Tractor.

- 1) Remove locking pin from bent pin.
- 2) Remove bent pin from the stalk stomper assembly.
- 3) Remove Torsion Unit and Shoe assembly



120 Eastgate Drive SE  
PO Box 7  
Hutchinson, MN 55350

1-800-788-6483  
1-320-587-2322  
1-320-587-6112 (Fax)

[WWW.MAYWES.COM](http://WWW.MAYWES.COM)

# Instructions

## Safety Procedure:

-Park Tractor on level ground and engage the parking brake

## Installation Procedure:

-Attach Vertical Mount (#41690) to mounting bracket\* on tractor with two (2) 3/4" Grade 5 bolts\*\*, two (2) flat washers\*\*, and two (2) 3/4" locking nuts\*\*. Minimum recommended bolt spacing on vertical mount is 6" (two holes between bolts).

## Note:

-Lift Arm Assembly must be mounted to allow for 2" of ground clearance to the bottom of the Stalk Stomper shoe when the entire assembly is in the operating (down) position (see figure 1). Also to allow for a minimum of 12" of clearance between the tractor tire/track and the back edge of the Stalk Stomper shoe when the lift assembly is in transport (up) position (see figure 2).

\* Tractor mounting bracket sold separately or supplied by the customer.

\*\* 3/4" Bolts, 3/4" Flat Washers & 3/4" Locking Nuts are recommended hardware and are not supplied with Lift Arm Assembly

Figure 1

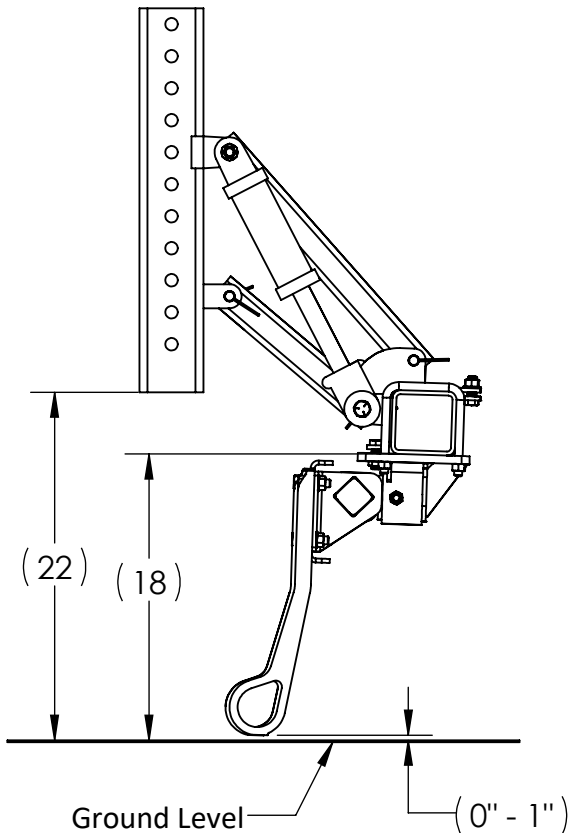
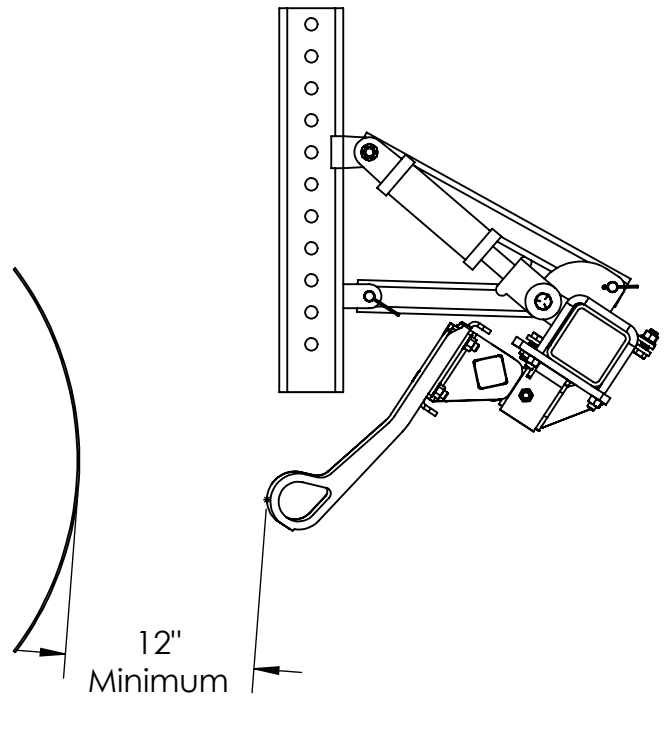
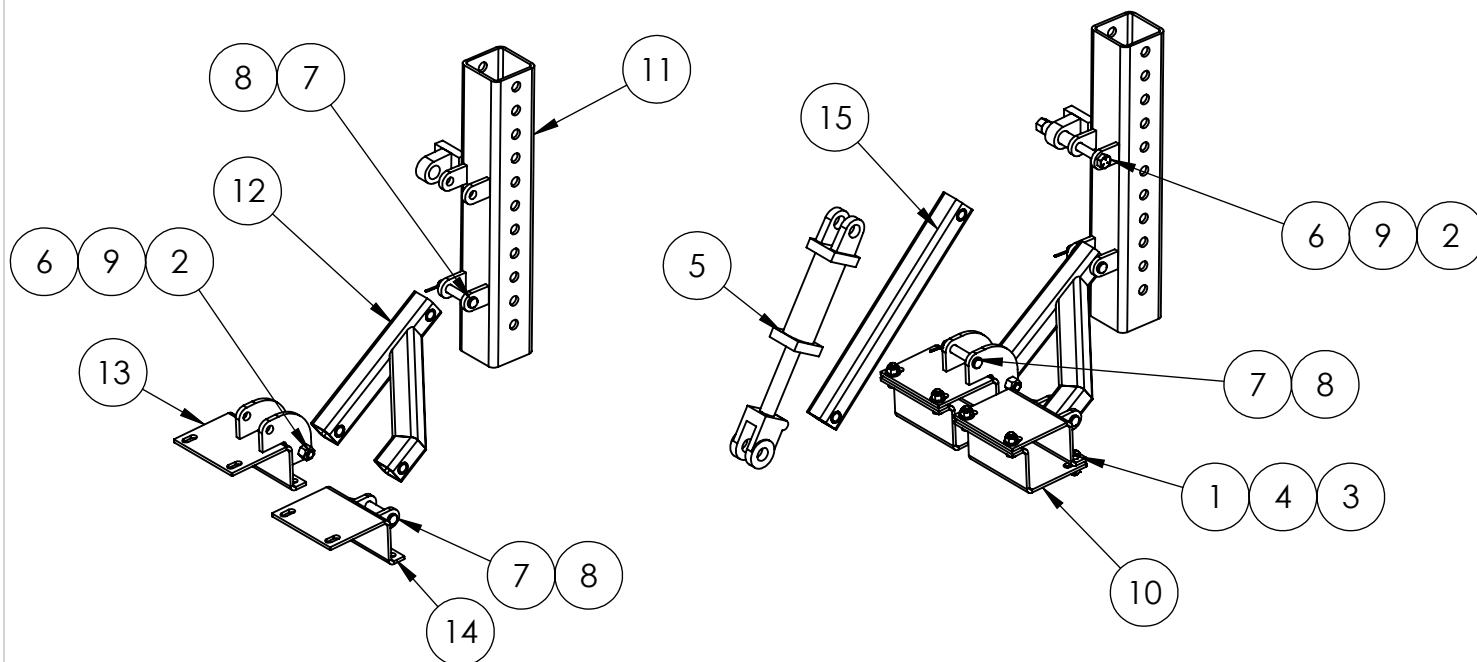

Figure 2



# 41688 - Tractor Stomper Left Lift Assembly



ITEM #	PART #	DESCRIPTION	QTY.
1	00135	BOLT, 1/2-13UNC X 1-1/2" GRADE 5	8
2	00197	NUT, 5/8-11 TOP LOCK	2
3	00216	NUT, 1/2" NC TOP LOCK	8
4	00253	WASHER, 1/2" SAE FLAT	8
5	00961		1
6	00962	BOLT, 5/8-11UNC X 7" LG	2
7	00963	CLEVIS PIN, 5/8" X 3-1/2"	3
8	00964	COTTER PIN, 1/8" X 2" LG	3
9	22255	SLEEVE BUSHING	2
10	22264	BOTTOM CLAMP, TSS	2
11	41690	LEFT VERTICAL MOUNT TSS	1
12	41692	LOWER CONNECTOR ARM TSS	1
13	41693	LARGE BRACKET TSS	1
14	41694	SMALL BRACKET TSS	1
15	41696	UPPER ARM TSS	1

## NOTES:

- To order a complete stalk stomper Left Lift Arm, use part number #41688
- To order individual service items, select item number from the illustration above and cross reference the parts list below for the part number and description.



120 Eastgate Drive SE  
Hutchinson, MN 55350

1-800-788-6483  
1-320-587-2322  
1-320-587-6112 (Fax)

WWW.MAYWES.COM

# 41689 - Tractor Stomper Right Lift Assembly

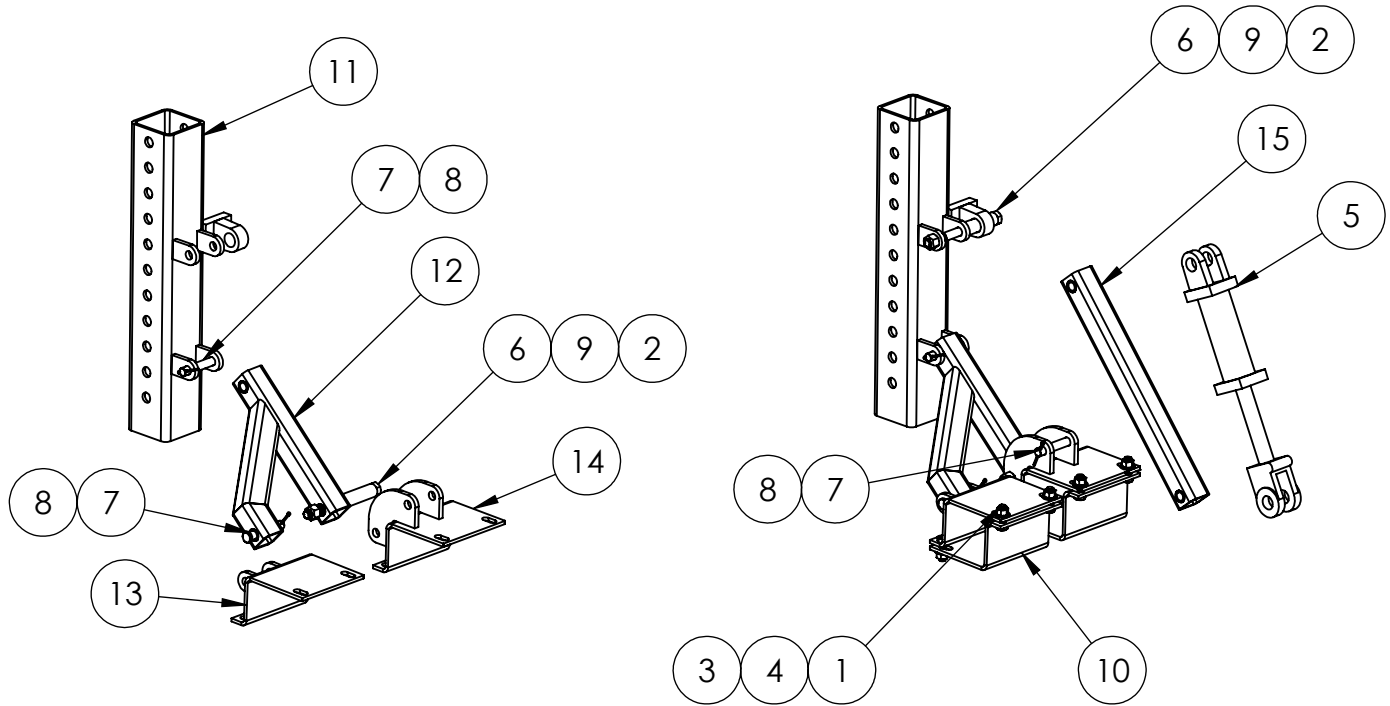

ITEM #	PART #	DESCRIPTION	QTY.
1	00135	BOLT, 1/2-13UNC X 1-1/2" GRADE 5	8
2	00197	NUT, 5/8-11 TOP LOCK	2
3	00216	NUT, 1/2" NC TOP LOCK	8
4	00253	WASHER, 1/2" SAE FLAT	8
5	00961		1
6	00962	BOLT, 5/8-11UNC X 7" LG	2
7	00963	CLEVIS PIN, 5/8" X 3-1/2"	3
8	00964	COTTER PIN, 1/8" X 2" LG	3
9	22255	SLEEVE BUSHING	2
10	22264	BOTTOM CLAMP, TSS	2
11	41691	VERTICAL MOUNT	1
12	41692	LOWER CONNECTOR ARM TSS	1
13	41694	SMALL BRACKET TSS	1
14	41695	LARGE BRACKET TSS	1
15	41696	UPPER ARM TSS	1

**NOTES:**

- To order a complete stalk stomper Right Lift Arm, use part number #41689
- To order individual sevice items, select item number from the illustration above and cross reference the parts list below for the part number and description.



120 Eastgate Drive SE  
Hutchinson, MN 55350

1-800-788-6483  
1-320-587-2322  
1-320-587-6112 (Fax)

WWW.MAYWES.COM

## Tractor Stalk Stomper Hydraulic Schematic

ITEM #	PART #	DESCRIPTION	QTY.
1	00961		2
2	00977	TEE JIC FITTING 6-6-8	2
3	00978	ELBOW JIC FITTING 6-8	2
4	00979	ADAPTER JIC FITTING 6-8	2
5	00970	COUPLING MALE NIPPLE	2
6	41704	HOSE 8FT WITH ENDS	2
7	41715	HOSE 25FT WITH ENDS	2
8	41716	HOSE 30FT WITH ENDS	2
9	41717	HOSE 35FT WITH ENDS	2

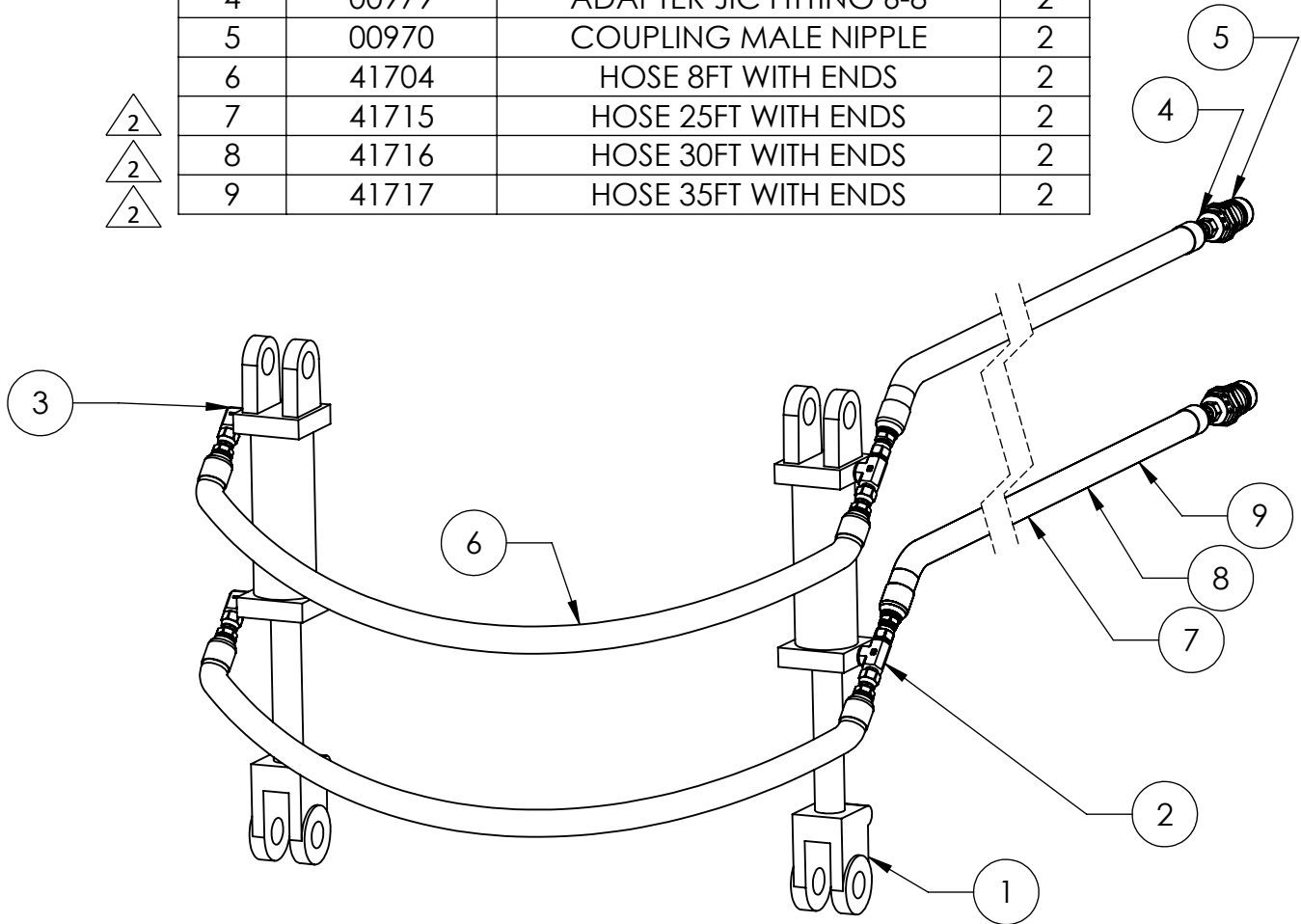
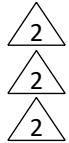

**Notes:**

1. Orientation of fittings may vary.

△ 2 Length of Hose will vary depending upon kit ordered.

3. Connection Options:

Option #1 (Recommended):

Connect hydraulics into an open remote on the tractor.

This allows for independent control and operation of the assembly in "float".

Option #2:

Connect hydraulics into an existing implement line allowing the

Tractor Stalk Stomper Assembly to raise and lower with the implement.

(Additional fittings required, but not included)



120 Eastgate Drive SE  
Hutchinson, MN 55350

1-800-788-6483  
1-320-587-2322  
1-320-587-6112 (Fax)

[WWW.MAYWES.COM](http://WWW.MAYWES.COM)

# 24" G4 Tractor Stomper Layouts

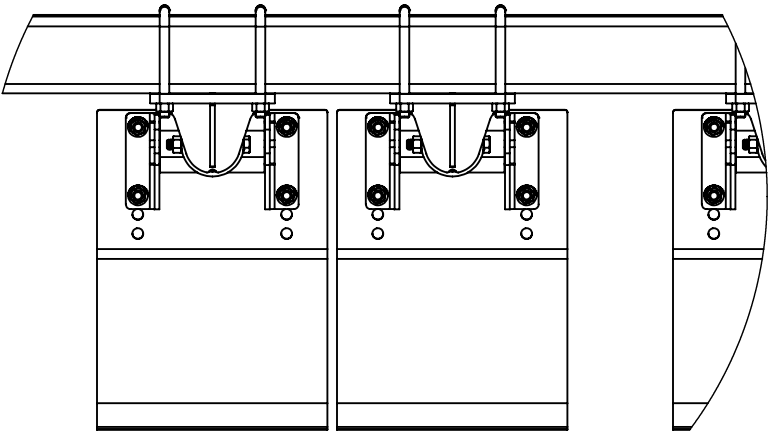
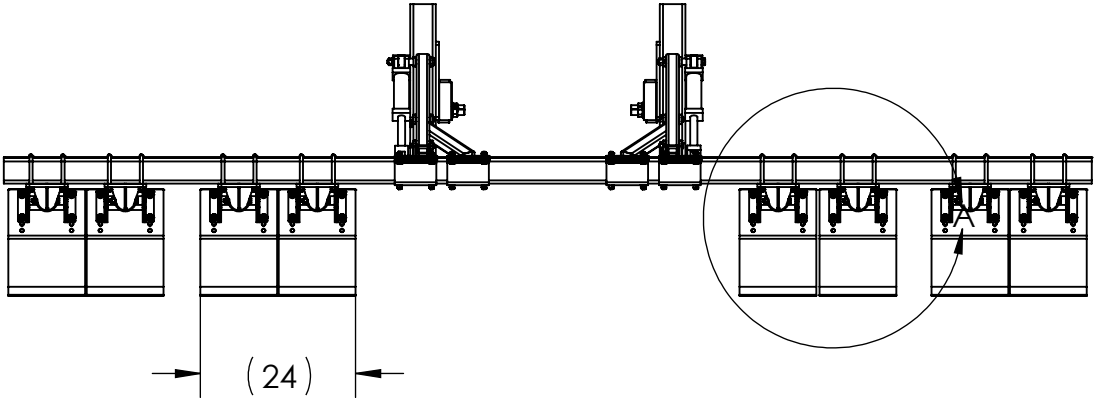

DETAIL A  
SCALE 1 : 10



**MAY WES**  
*Original Poly People*  
A DIVISION OF PRIDE SOLUTIONS

120 Eastgate Drive SE  
Hutchinson, MN 55350

1-800-788-6483  
1-320-587-2322  
1-320-587-6112 (Fax)

[WWW.MAYWES.COM](http://WWW.MAYWES.COM)

# 43105

## Single Tractor Stomper

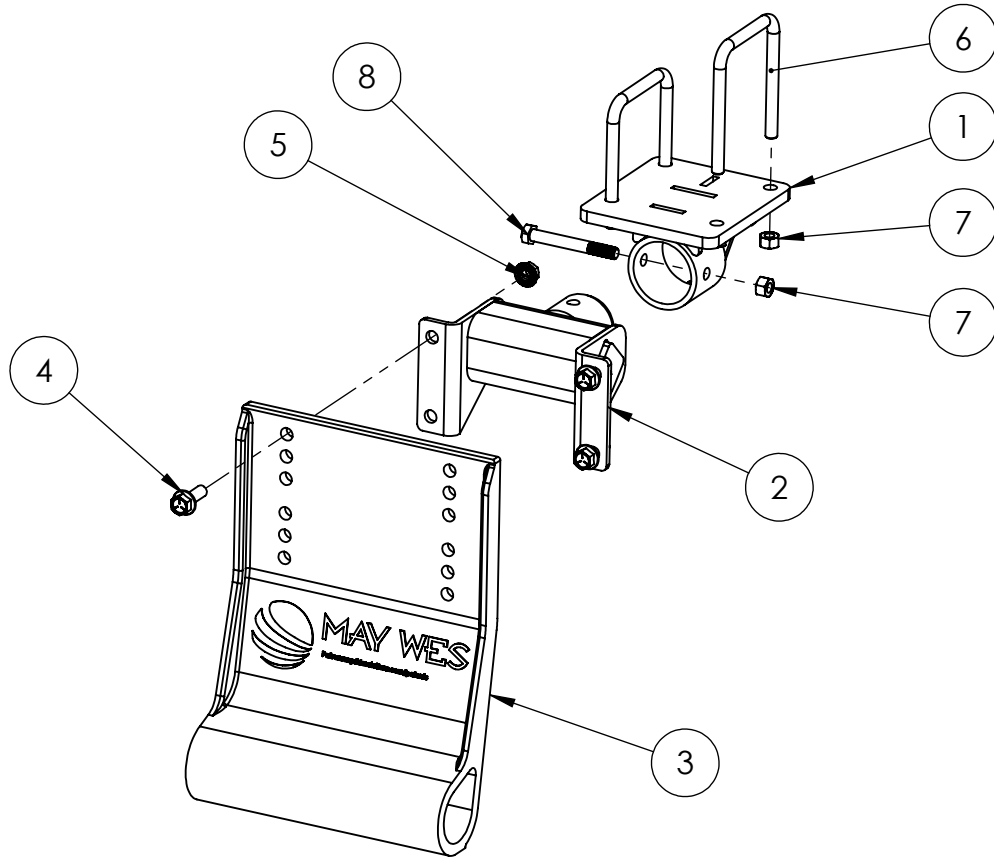

ITEM #	PART #	DESCRIPTION	QTY.
1	43106	BRACKET, G4 TRACTOR SS	1
2	42295	STALK STOMPER TORSION ASSY	1
3	24100	SHOE, G4 MOLDED	1
4	00729	BOLT, 1/2"-13 X 1-1/2" HEX FLANGE	4
5	00730	NUT, 1/2"-13 HEX FLANGE	4
6	00965	U-BOLT 1/2-13	2
7	00216	NUT, 1/2" NC TOP LOCK	5
8	00154	BOLT, 1/2 - 13UNC X 4"	1



120 Eastgate Drive SE  
Hutchinson, MN 55350

1-800-788-6483  
1-320-587-2322  
1-320-587-6112 (Fax)

[WWW.MAYWES.COM](http://WWW.MAYWES.COM)

# 36" G4 Tractor Stomper Layouts

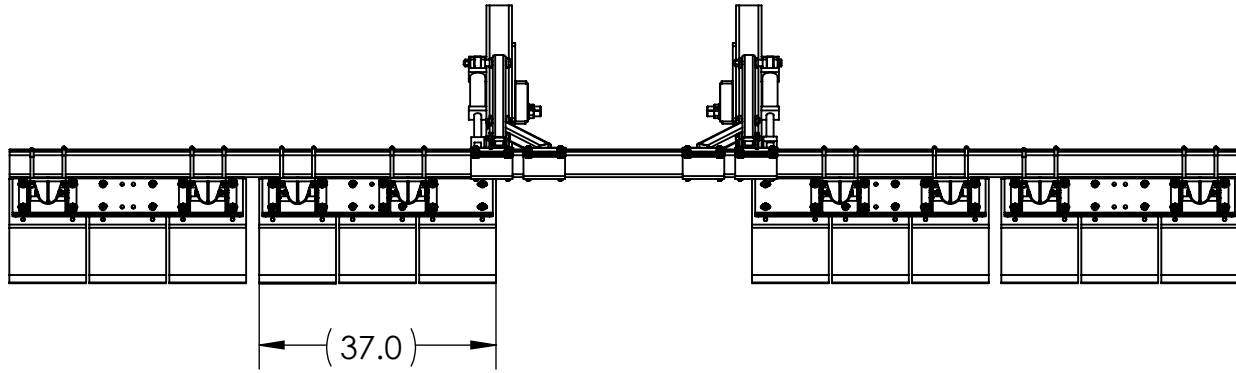

**Centered Layout**  
No Drilling required

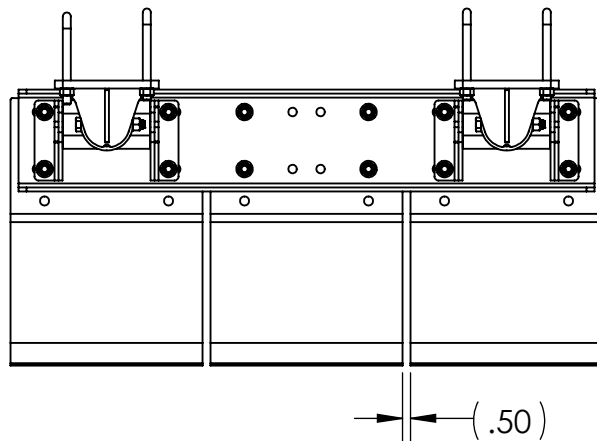

**Right Offset Layout**

Note: Drilling through shoe is required in 2 locations

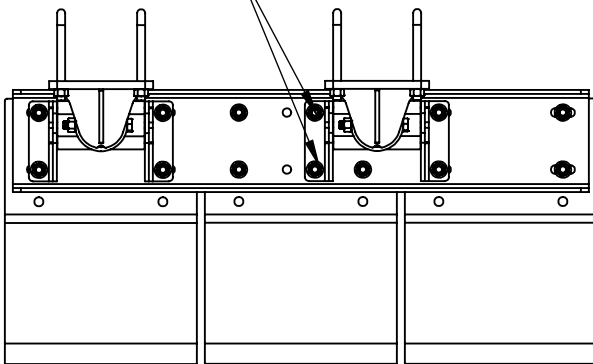

**Left Offset Layout**

Note: Drilling through shoe is required in 2 locations

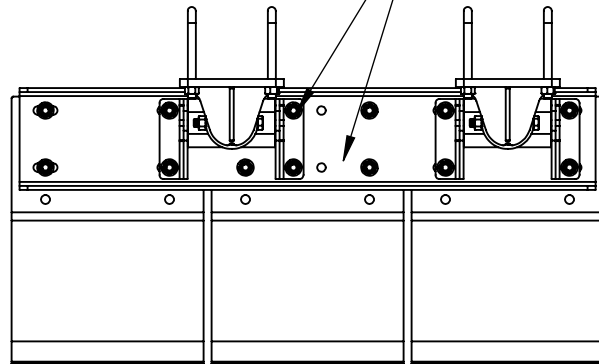

120 Eastgate Drive SE  
Hutchinson, MN 55350

1-800-788-6483  
1-320-587-2322  
1-320-587-6112 (Fax)

[WWW.MAYWES.COM](http://WWW.MAYWES.COM)



# 42396

## G4 Triple Tractor Stomper

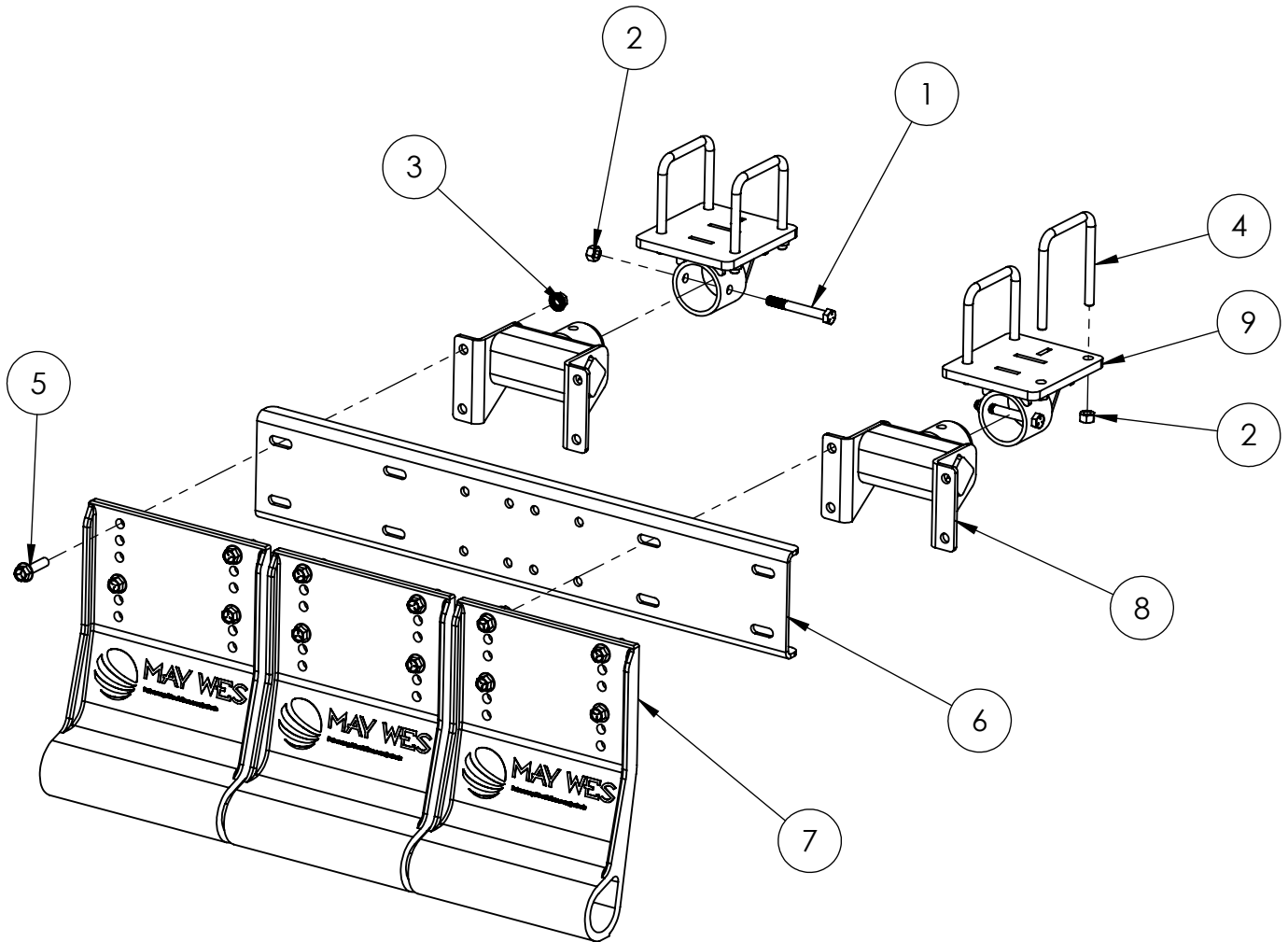

ITEM #	PART #	DESCRIPTION	QTY.
1	00154	BOLT, 1/2 - 13UNC X 4"	2
2	00216	NUT, 1/2" NC TOP LOCK	10
3	00730	NUT, 1/2"-13 HEX FLANGE	12
4	00965	U-BOLT 1/2-13	4
5	01139	BOLT, 1/2-13 X 2" HEX FLANGE	12
6	22863	PLATE, TRCTR STOMPER OFFSET	1
7	24100	SHOE, G4 MOLDED	3
8	42295	STALK STOMPER TORSION ASSY	2
9	43106	BRACKET, G4 TRACTOR SS	2



120 Eastgate Drive SE  
Hutchinson, MN 55350

1-800-788-6483  
1-320-587-2322  
1-320-587-6112 (Fax)

[WWW.MAYWES.COM](http://WWW.MAYWES.COM)